

# U. S. PUBLIC LAND SURVEY MONUMENT RECORD

**INSTRUCTIONS :**

This record shall show the location of the corner and shall include all of the following nine elements (a through i).

- (a) Identify the corner by reference to the U.S. public land survey system.
- = Corner monument restored.

*E 1/4 CORNER, SEC. 19  
T3N, R1W, PLATHEVILLE  
TWP., GRANT CO., WI.*

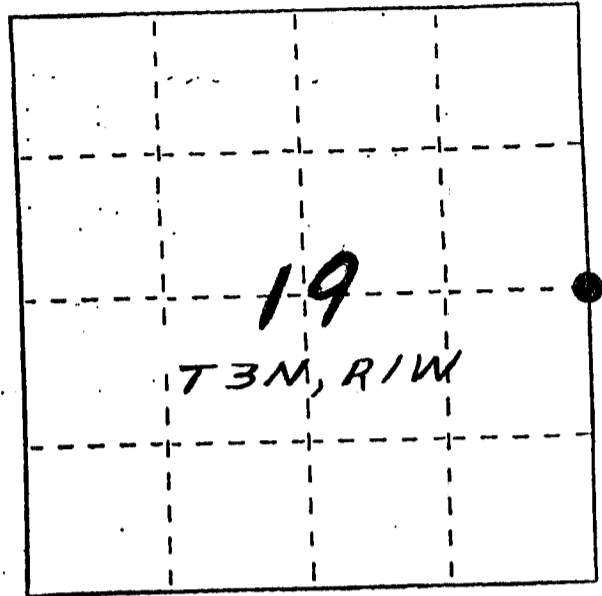

*any other material evidence, such as old maps, old photographs, evidence, testimonial evidence or any other material evidence you can locate, and where the monument was found or placed.  
MONUMENT WAS PLACED... LOCATION DETERMINED BY  
OCCUPATIONAL EVIDENCE & VERIFIED BY EDM  
TRAVERSE OF THE AREA.*

- (c) In the plan view drawing below, provide reference ties to at least 4 witness monuments, or, if the location is within a municipality, to at least 2 witness monuments. (Witness monuments shall be made of concrete, natural stone, iron or other equally durable material.) Describe witness monuments.
- (d) Show a plan view drawing depicting the relevant monuments and reference ties which is sufficient in detail to enable accurate relocation of the corner monument if the corner monument is disturbed. Indicate north.

● GRANT CO. ALUM.  
MONUMENT SET.  
○ 1/2" X 24" REBAR SET  
X EXISTING FENCES

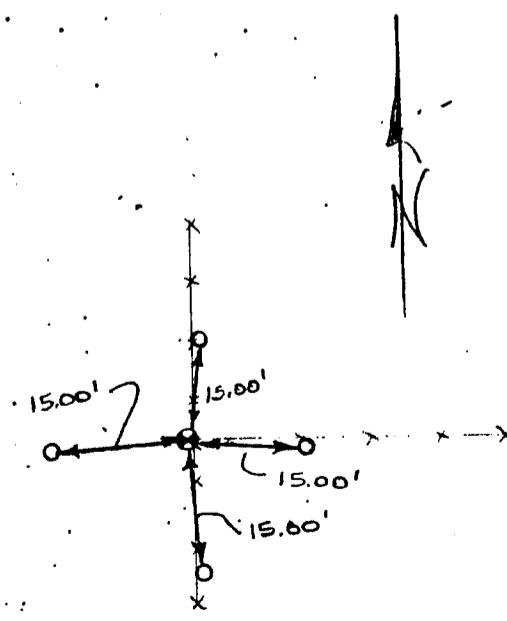

JUN 7 1988