

11/16/95 X

# LAFAYETTE COUNTY

## Survey Monument Record

CORNER NO. 21  
SECTION 6  
TOWN 3N  
RANGE 1E

TYPE OF MONUMENT 1" IRON ROD FND.  
STATE PLANE COORDINATES: N \_\_\_\_\_  
E \_\_\_\_\_  
ELEVATION — M.S.L. DATUM: \_\_\_\_\_  
THETA ANGLE: \_\_\_\_\_  
FIELD BOOK: \_\_\_\_\_  
PAGE \_\_\_\_\_

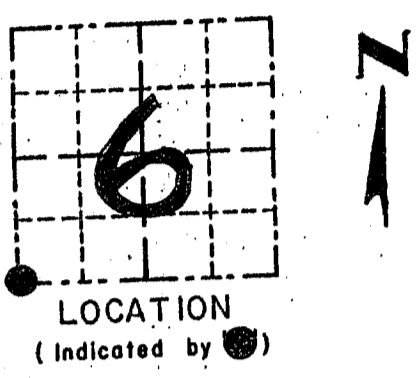

### BASIS FOR MONUMENT LOCATION

(Use reverse side if necessary)  
Show info such as: History of corner, with reference to Vol. and pg., dates, surveyor; exact description of monument replaced; if location computed, by taped or EDM traverse; landowner, remarks, etc.

SEAL:

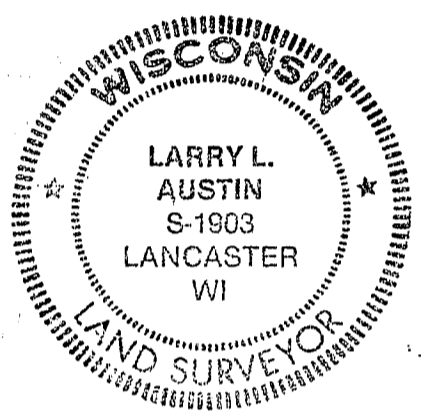

NO RECORD OF CORNER  
FOUND SINCE ORIGINAL SURVEY.  
FOUND A 1" BAR IN N-S  
FENCE ROW. ACCEPTED ITS  
LOCATION AFTER VERIFICATION  
BY EDM TRAVERSE.

CERTIFIED CORRECT

Larry L. Austin  
Registered Land Surveyor  
DATE: 1-16-95

### TIE SKETCH

Show at least three (3) ties and monument

#### LEGEND

- 1" IRON BAR FND.
- 1" X 12" IRON PIPE SET
- XX EXISTING FENCE

