

U. S. PUBLIC LAND SURVEY MONUMENT RECORD

INSTRUCTIONS :

This record shall show the location of the corner and shall include all of the following nine elements (a through i).

- (a) Identify the corner by reference to the U.S. public land survey system.
- = Corner monument restored.

NE Corner of Section 4

T 2 N R 3 W

Town of Potosi (South Part)

Grant Co., Wis.

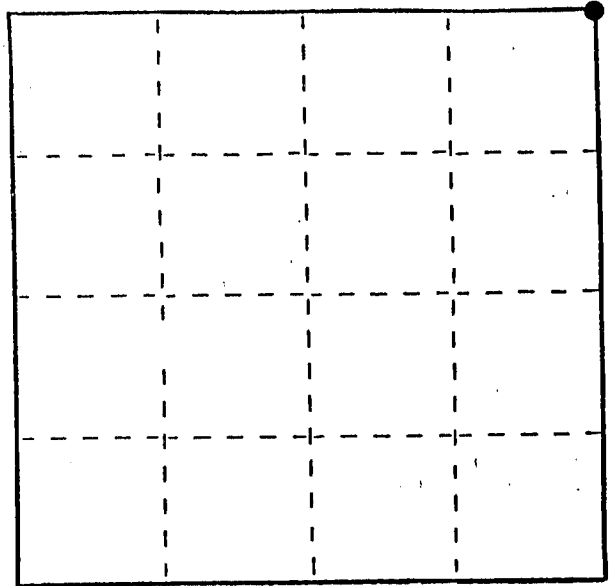

Section 4 T2N R3W

- (b) Describe any record evidence, monument evidence, occupational evidence, testimonial evidence or any other material evidence you considered, and whether the monument was found or placed.

Originally established by Lucius Lyon in the 1st 1/4 of 1833, re-established by Dennis Snyder, RLS, in CSM #283, dated (not shown on face of map). Corner shown as iron rod set, size not specified. Found 8 penny nail at the corner and at locations of other points shown on map. A telephone call to Mr. Snyder, in Illinois, confirmed the corner had not yet been placed, but the nail was at the correct location. He informed me he would be setting the corner very shortly, and send a tie sheet. Approximately 3 weeks later I inquired again, while asking if he knew how to contact Mr. Brashaw. Nearing the end of my project in the area, approximately 6 weeks later, I replaced the nail with a Wis. Dept. of Transportation aluminum monument.

- (c) In the plan view drawing below, provide reference ties to at least 4 witness monuments, or, if the location is within a municipality, to at least 2 witness monuments. (Witness monuments shall be made of concrete, natural stone, iron or other equally durable material.) Describe witness monuments.

- (d) Show a plan view drawing depicting the relevant monuments and reference ties which is sufficient in detail to enable accurate relocation of the corner monument if the corner monument is disturbed. Indicate north.

Scale: 1" = 20'

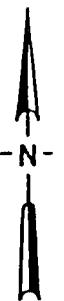

(Bearings shown are for orientation purposes only)

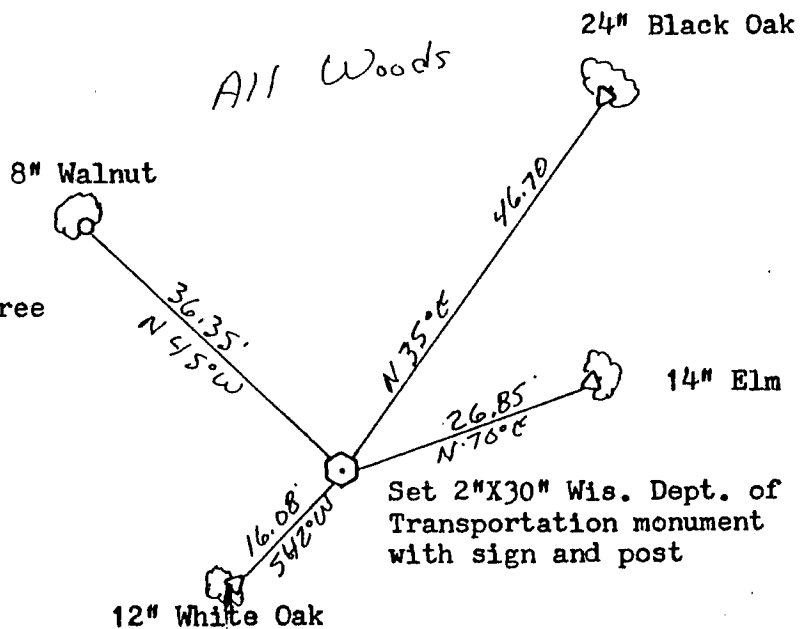

60# Spike set in base of blazed tree

3/4" Rebar set at base of tree (no blaze)

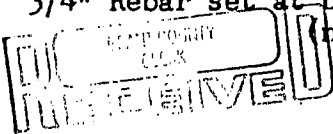

SEP. 13 1989



(e) Describe any material discrepancy between the location of the corner as restored or reestablished and the location of that corner as previously restored or reestablished by distance and direction. Show the discrepancy on the plan view drawing under (d), above. Show the distances between the corner as previously restored or reestablished and (1) the corner as restored or reestablished, and (2) to at least 2 of the witness monuments shown on the drawing in (d), above.

None .

(f) Was the corner restored through acceptance of (1) an obliterated evidence location, or, (2) a found perpetuated location?

Found perpetuated location

(g&h) Was the corner reestablished through lost corner proportionate methods? If so, show the method, including the directions and distances to other public land survey corners used as evidence or used for proportioning in determining the corner location?

No

(i) I, F. Curtis Crook
(type or print name) certify that the corner location shown on this record was determined by me or under my direction and control and that this U.S. Public Land Survey Monument Record is correct and complete to the best of my knowledge and belief.

F. Curtis Crook

5-25-89

