

# SECTION CORNER TIES

TO THE SOUTHWEST CORNER OF SECTION 23, TOWN 14N R1E,  
RANGE 2 WEST, JAMESTOWN TOWNSHIP, GRANT CO., WIS.

I, Bruce D. Rowden, hereby certify that I have complied with the Wisconsin Statutes, The Statutes of the United States, and the rules and regulations made by the Secretary of the Interior in the location of the corner shown below.

April 4, 1973

*Bruce D. Rowden*  
Bruce D. Rowden R.L.S. - 150

*Jamestown Twp*

RECEIVED  
Grant Co. Hwy. Comm.  
Jamestown, WI 53013

JUL 11 1978

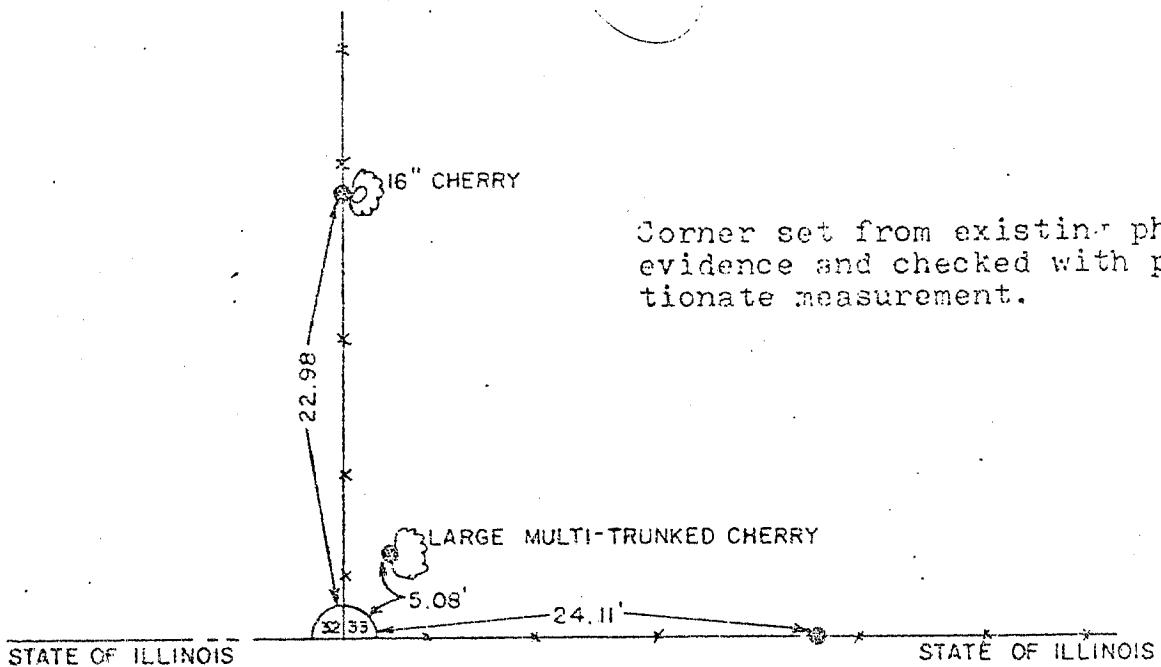
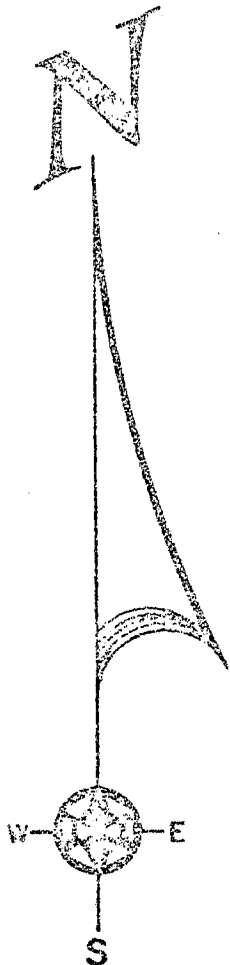

Corner set from existing physical evidence and checked with proportionate measurement.

STATE PLANE COORDINATES:  
NORTH 185807.67  
EAST 1832062.54

## LEGEND



4" x 30" ROUND CAST ALUMINUM MONUMENT (TOP AT GRADE)



3/4" x 24" IRON ROD

N 185807.67  
E 1832062.54

TALARCZYK & ASSOC., INC.

110 E. Division Street  
DODGEVILLE, WI 53533

Phone 201/935-1301

COK D. I. PAGE 47  
SB NO. 185807.67  
RECORDED  
DRAWN BY

SCALE: 1" = 10'

139