

SECTION CORNER TIES

TO THE EAST 1/4 CORNER OF SECTION 28, TOWN 1 NORTH,
RANGE 2 WEST, FOURTH PRINCIPLE MERIDIAN, JAMESTOWN
TOWNSHIP, IRANI COUNTY, WISCONSIN.

Jamestown

I, Bruce D. Bowden, hereby certify that I have
complied with the Wisconsin Statutes, the Statutes
of the United States, and the rules and regulations
made by the Secretary of the Interior in the
location of the corner shown below.

April 4, 1978

Bruce D. Bowden
Bruce D. Bowden R.L.S.-1250

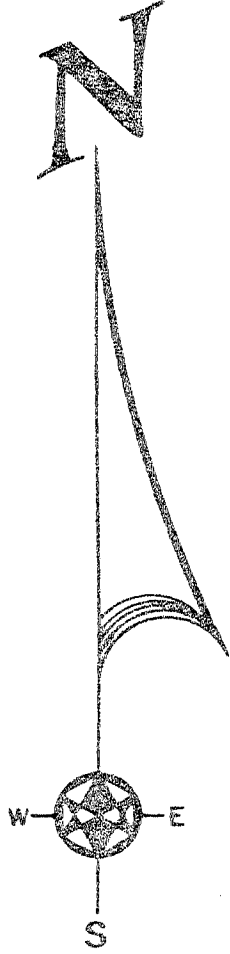

LEGEND

- 4" x 30" CAST ALUMINUM MONUMENT (AT GRADE)
- 3/4" x 24" IRON ROD.

Corner set by existing physical
evidence and checked with single
proportional measurement, plus
this corner was recorded on a
previous survey.

PLANE COORDINATES
NORTH 193715.005
EAST 193744.261

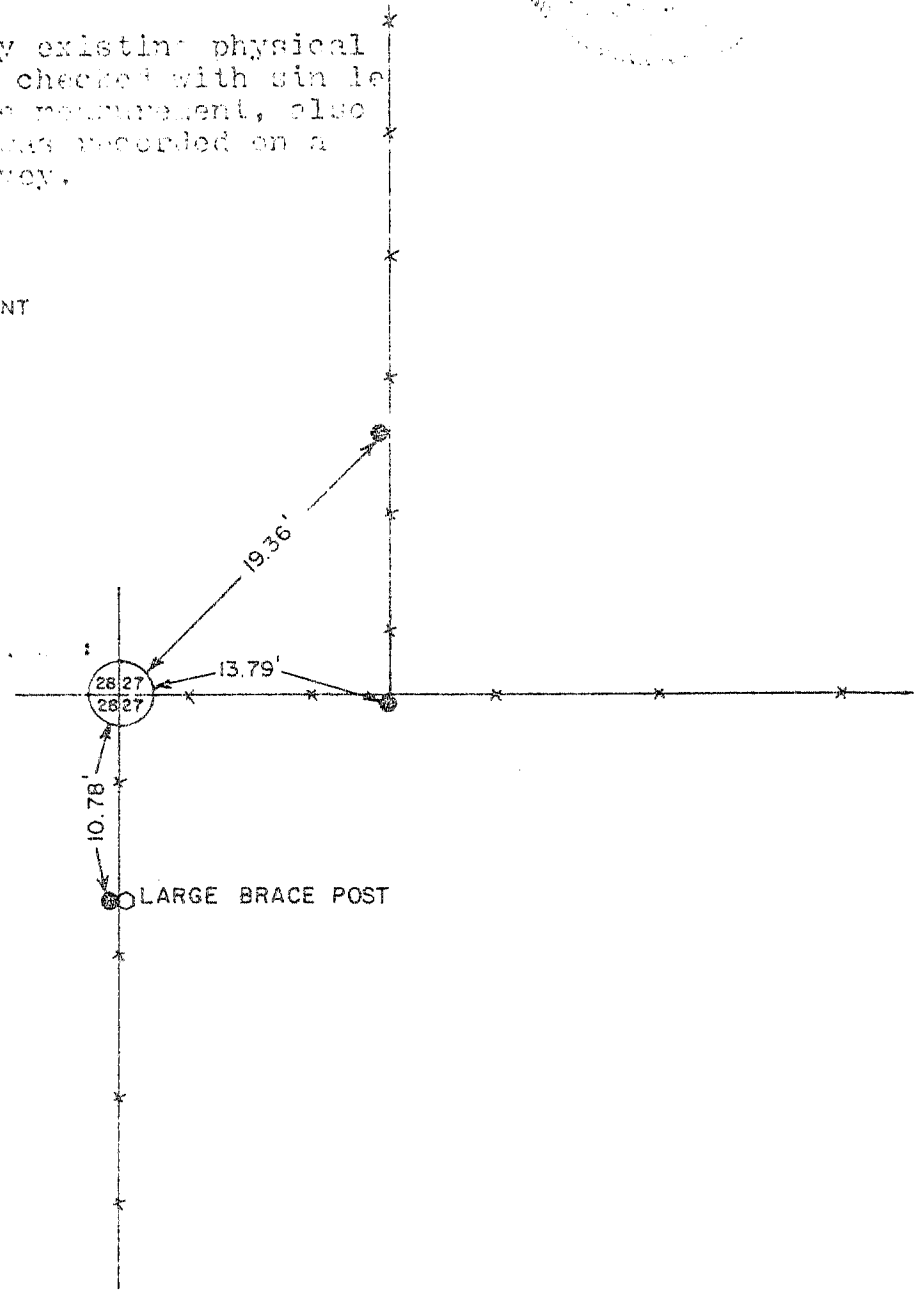

BOOK 0-1 PAGE 47
JOB NO. D-78007
CHECKED *RJM*
DRAWN BY *RJM*

SCALE: 1" = 10'

TALARCZYK & ASSOC., INC.

110 E. Division Street
DODGEVILLE, WI 53533

Phone 608/935-5301

Page 7