

REC'D AUG 12 1997  
Sec 33 T3N, R2W

# SURVEY PLAT

PREPARED FOR MIKE BLINDERT

## LEGEND

- 3/4" x 24" IRON BAR SET
- 3/4" IRON BAR FOUND
- R= RECORDED AS
- EXISTING FENCE—FOR REFERENCE ONLY

## BEARING REFERENCE

BEARINGS REFERENCED TO THE NORTH-SOUTH  
1/4 LINE OF SECTION 33 WHICH IS ASSUMED TO  
BEAR N 00°06'06" E.



NORTH 1/4 SECTION 33,  
T3N R2W, 4TH P.M., GRANT  
COUNTY, WISCONSIN  
3/4" IRON BAR FOUND

PROPORTED SW COR, SW 1/4, NE 1/4  
SEC 33, PER CARL SCHOENHARD

53.13 ACRE SURVEY  
BY CARL SCHOENHARD  
DATED APRIL OF 1978

C.T.H. "O"

3.794 ACRES ±

P.O.B. EASEMENT

TERMINUS POINT EASEMENT

33' WIDE INGRESS-  
EGRESS EASEMENT

P.O.B.  
PROPERTY

## EASEMENT TABULATIONS

A	S 16°07'13" E 88.28'
B	S 43°20'42" E 28.63'
C	N 89°31'47" E 43.77'
D	N 76°20'29" E 53.81'
E	N 65°26'17" E 45.26'
F	N 55°22'22" E 32.13'
G	N 81°09'31" E 131.70'
H	N 82°48'31" E 63.28'
I	N 70°56'17" E 106.82'
J	N 82°02'13" E 60.75'
K	S 88°21'34" E 46.72'
L	S 74°49'57" E 23.00'
M	S 57°13'23" E 37.23'
N	S 52°53'48" E 77.32'
O	S 32°23'11" W 38.66'

53.13 ACRE SURVEY  
BY CARL SCHOENHARD  
DATED APRIL OF 1978

SOUTH 1/4 CORNER SECTION 33  
T3N R2W, 4TH P.M., GRANT CO., WI.  
3/4" IRON BAR SET



NOTE: MARKER IS RESET FROM THE  
51.13 ACRE SURVEY BY CARL  
SCHOENHARD DATED APRIL OF 1978.

## NOTE:

THE CENTERLINE AND R.O.W. IS ESTABLISHED FROM PLAT OF  
R.O.W. OF C.T.H. "O" BRIDGE BR #1-88 & #2-88  
DATED 7-7-88, AND DOES NOT NECESSARILY FOLLOW  
THE CENTERLINE AS SURVEYED BY CARL SCHOENHARD  
DATED APRIL OF 1978.

### AUSTIN ENGINEERING - LARRY L. AUSTIN

4211 S.T.H. 81E., LANCASTER, WI., 53813  
PHONE: 608-723-6363 FAX: 608-723-6702

DRAWN BY: SW AUSTIN  
APPROVED: LL AUSTIN  
CREW: BS - DK  
FIELDBOOK: 97-11  
C:\SURVEY3\T3NR2W\33  
C:\EPSA\PROGRAM\T3NR2W\33

# SURVEY PLAT

PREPARED FOR MIKE BLINDERT

## PROPERTY DESCRIPTION

OF A PARCEL OF LAND LOCATED IN THE NORTHEAST 1/4 OF THE SOUTHWEST 1/4, SOUTHWEST 1/4 OF THE NORTHEAST 1/4, AND THE NORTHWEST 1/4 OF THE SOUTHEAST 1/4 OF SECTION 33, T3N R2W OF THE 4TH P.M., GRANT COUNTY, WISCONSIN, SAID PARCEL BEING MORE PARTICULARLY DESCRIBED AS FOLLOWS:  
COMMENCING AT THE SOUTH 1/4 CORNER OF SECTION 33, T3N R2W OF THE 4TH P.M., GRANT CO., WI.;  
THENCE N 00°06'06" E 2179.53' TO A POINT ON THE NORTH-SOUTH 1/4 LINE OF SAID SECTION 33;  
THENCE N 25°11'50" W 339.96' TO A 3/4" IRON BAR MARKING THE POINT OF BEGINNING;  
THENCE N 25°11'50" W 87.98' TO A 3/4" IRON BAR IN THE ROW OF C.T.H. "O";  
THENCE N 69°26'50" E 354.57' TO A 3/4" IRON BAR IN SAID ROW;  
THENCE EASTERLY 344.36' ON THE ARC OF CURVE CONCAVE SOUTHERLY HAVING A RADIUS OF 768.51' AND A LONG CHORD WHICH BEARS N 82°12'25" E 341.48';  
TO A 3/4" IRON BAR IN SAID R.O.W.;  
THENCE S 84°58'51" E 166.20' TO A 3/4" IRON BAR IN SAID R.O.W.;  
THENCE N 05°01'09" E 17.00' TO A 3/4" IRON BAR IN SAID ROW;  
THENCE S 84°58'53" E 128.26' TO A 3/4" IRON BAR IN SAID ROW AND MARKING A CORNER OF A SURVEY BY CARL SCHOENHARD DATED APRIL OF 1978;  
THENCE S 00°00'17" E 336.09' TO A 3/4" IRON BAR ON A LINE OF SAID SURVEY;  
THENCE S 86°43'03" W 185.37' TO A 3/4" IRON BAR;  
THENCE N 25°44'17" W 83.78' TO A 3/4" IRON BAR;  
THENCE N 16°19'06" W 111.16' TO A 3/4" IRON BAR;  
THENCE N 49°39'36" W 88.08' TO A 3/4" IRON BAR;  
THENCE N 79°33'38" W 24.41' TO A 3/4" IRON BAR;  
THENCE S 87°39'11" W 37.08' TO A 3/4" IRON BAR;  
THENCE S 77°52'16" W 47.06' TO A 3/4" IRON BAR;  
THENCE S 72°12'04" W 57.92' TO A 3/4" IRON BAR;  
THENCE S 77°22'35" W 338.64' TO A 3/4" IRON BAR;  
THENCE S 72°57'18" W 120.53' TO THE POINT OF BEGINNING, CONTAINING 3.794 ACRES, MORE OR LESS, AND BEING SUBJECT TO ANY AND ALL EASEMENTS OF RECORD.

## EASEMENT DESCRIPTION

A 33' WIDE INGRESS-EGRESS EASEMENT, THE CENTERLINE OF WHICH IS DESCRIBED AS FOLLOWS;  
COMMENCING AT THE SOUTH 1/4 CORNER OF SECTION 33, T3N R2W OF THE 4TH P.M., GRANT COUNTY, WISCONSIN;  
THENCE N 00°06'06" E 2179.53' TO A POINT ON THE NORTH-SOUTH 1/4 LINE OF SAID SECTION 33;  
THENCE N 25°11'50" W 478.37' TO A POINT IN THE CENTERLINE OF C.T.H. "O";  
THENCE N 69°26'50" E 38.04' TO A POINT IN SAID CENTERLINE, SAID POINT BEING THE POINT OF BEGINNING;  
THENCE S 16°07'13" E 88.28';  
THENCE S 43°20'42" E 28.63';  
THENCE N 89°31'47" E 43.77';  
THENCE N 76°20'29" E 53.81';  
THENCE N 65°26'17" E 45.26';  
THENCE N 55°22'22" E 32.13';  
THENCE N 81°09'31" E 131.70';  
THENCE N 82°48'31" E 63.28';  
THENCE N 70°56'17" E 106.82';  
THENCE N 82°02'13" E 60.75';  
THENCE S 88°21'34" E 46.72';  
THENCE S 74°49'57" E 23.00';  
THENCE S 57°13'23" E 37.23';  
THENCE S 52°53'48" E 77.32';  
THENCE S 32°23'11" W 38.66' TO THE TERMINUS POINT.

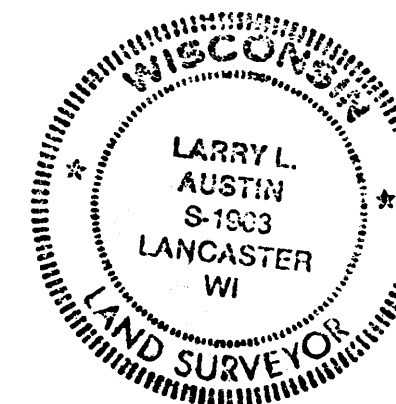

## SURVEYOR'S CERTIFICATE

I, LARRY L. AUSTIN, REGISTERED WISCONSIN LAND SURVEYOR, DO HEREBY CERTIFY THAT THE ABOVE DESCRIPTION WAS SURVEYED, MAPPED AND MONUMENTED BY ME OR UNDER MY DIRECT SUPERVISION ALL IN ACCORDANCE WITH THE INSTRUCTIONS OF MIKE BLINDERT, AND TO THE BEST OF MY KNOWLEDGE AND BELIEF, THIS PLAT IS AN ACCURATE REPRESENTATION THEREOF.

  
LARRY L. AUSTIN R.L.S. 1903      6/11/97  
DATE

DRAWN BY: SW AUSTIN  
APPROVED: LL AUSTIN  
CREW: BS - DK  
FIELDBOOK: 97-11  
C:\SURVEY3\T3NR2W\33  
C:\EPSA\PROGRAM\T3NR2W\33MB

**AUSTIN ENGINEERING - LARRY L. AUSTIN**

4211 S.T.H. 81E., LANCASTER, WI., 53813  
PHONE: 608-723-6363 FAX: 608-723-6702