

Sec 34, T8N, R3W
BOUNDARY AND SITE MAP
 FOR KJELL AND NANCY KASHAGEN

Z 84
 RECD AUG 26 1997

LOCATED IN THE NORTHEAST QUARTER OF THE SOUTHEAST
 QUARTER OF SECTION 34, TOWN 8 NORTH, RANGE 3 WEST,
 CITY OF BOSCOBEL, GRANT COUNTY, WISCONSIN

3.25 acres±
 141,863 sq. ft.

NOTE: BEARINGS ARE REFERENCED TO THE GRANT COUNTY COORDINATE SYSTEM AS DEFINED BY THE WIS. DEPARTMENT OF TRANSPORTATION AND DETERMINED BY GPS OBSERVATION.

CURVE A-B

Δ	13° 53' 48"
R	2915.00'
C	705.28'
Brg	S 37° 33' 23" E

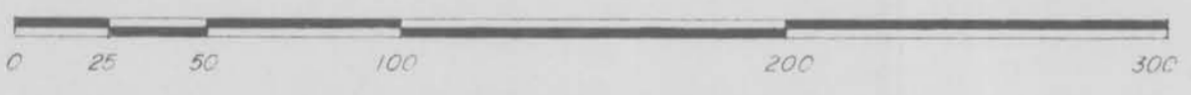

LEGEND

- ◆ CITY OF BOSCOBEL ALUMINUM MONUMENT - FOUND
- 1" DIAMETER IRON PIPE - FOUND
- 1 1/2" DIAMETER IRON PIPE - FOUND
- No. 6 REINFORCING ROD - FOUND
- ▲ MASONRY NAIL - FOUND
- ▣ R/W POST - FOUND
- ⊙ No. 6 x 24" REINFORCING ROD - SET
- ⊗ STORM SEWER MANHOLE
- ⊕ CATCH BASIN

CONTOUR INTERVAL = 1'

SURVEYOR'S CERTIFICATE

I BRUCE D. BOWDEN, REGISTERED WISCONSIN LAND SURVEYOR - 1250, DO HEREBY CERTIFY THAT I HAVE SURVEYED, DIVIDED, MAPPED AND MONUMENTED THE PROPERTY DESCRIBED HEREON IN ACCORDANCE WITH THE INSTRUCTIONS OF KJELL AND NANCY KASHAGEN, AS PER THEIR AGENT MR. BOB ELLIOT, AND THAT THIS MAP IS A CORRECT REPRESENTATION THEREOF TO THE BEST OF MY KNOWLEDGE AND BELIEF.

Bruce D. Bowden
 BRUCE D. BOWDEN, R.L.S. 1250
 DATE July 21, 1997

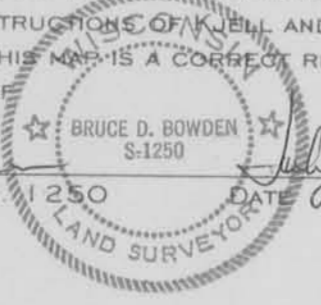

BOWDEN SURVEYING, LTD.
 619 W. MERRIMAC STREET
 DODGEVILLE, WI 53533
 PHONE (608) 935-5513

