

REC'D JUN 23 1997

13

# PLAT OF SURVEY

FOR: KRIS HAUSER (REALTOR)  
WANDA RUX (OWNER)

SHEET 1 OF 2



FOUND ALUMINUM MONUMENT NW CORNER

N 89°46'25" W  
2667.21'



FOUND ALUMINUM MONUMENT NE 1/4 CORNER

ENLARGED 5X

S 0°01'34" E  
150'

VOL. 334 PG. 78

THESE LINES WERE MONUMENTED AND DESCRIBED AS OCCUPIED FOR THE PURPOSE OF ACQUESCENCE WITH THE ADJOINING LANDOWNERS TO THE LINES DESCRIBED.

VOL. 730 PG. 533

N 89°30'52" E

(462)

(468.34)

(487.15)

318.42'

311.07'

(110.5)

(118.21)

(135.5)

2045.00'

2045.00'

SURVEY BY LAURENCE SCHMIT FOR RODNEY RUX DATED 08/11/14

### LEGEND:

- 1" X 24" X 1.13 #1/2 IRON PIPE SET
- 1-1/4" X 24" X 1.13 #1/2 (MIN. WT.) IRON PIPE SET
- ▲ 3/4" IRON ROD SET
- △ IRON ROD FOUND
- ▽ IRON PIPE FOUND
- (X) FENCE
- ( ) RECORDED AS
- (+ ) NO MONUMENT PLACED



PLAT BEARINGS ARE REFERENCED TO THE NORTH LINE OF THE NW 1/4 OF SECTION 34, T4N, R37W WHICH IS RECORDED TO BEAR N 89°46'25" W.

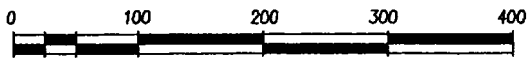

GRAPHIC SCALE ORIGINAL DRAWING SCALE: 1" = 100'

1.17 ACRES ±

LANDS PURPORTEDLY OCCUPIED BY RUX SINCE 1975

(EAST, 903.3')

VOL. 504 PG. 385

487.64'

506.30'

N 89°46'25" W  
(EAST, 300')

VOL. 306 PG. 493

NORTHWESTERLY  
N 04°31'42" W  
225.34'

S 56°51'39" W  
315.02'

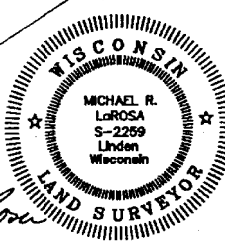

Michael R. LoRosa  
4/8/1997

TOWNSHIP OF BOSCOBEL

CITY OF BOSCOBEL

OFFICE DATA:	
JOB I.D.:	975-60
SURVEY CREW:	DM/BB
FIELD BOOK NO.:	97-2
DWG. STORED:	VERSIBLER
DRAWN BY:	ML
DRAWING NO.:	0100475-B0016
DATA FILE NO.:	0100475-B0016

COMPUTED CENTER OF SECTION

SCHMIT ENGINEERING & SURVEYING  
215 E. GRACE ST DODGEVILLE, WI. 53533 (608)935-2721

13

Plat of survey  
For: Kris Hauser (Realtor)  
Wanda Rux (Owner)  
Job #97s-60  
Sheet 2 of 2

**PARCEL DESCRIPTION:**

A parcel of land located in part of the NE 1/4 of the NW 1/4 of Section 34, T8N, R3W, Grant County, Wisconsin, to wit:

Commencing at the N 1/4 CORNER of said Section 34; thence S 0° 03' 44" E, 468.34' to the POINT OF BEGINNING; thence continuing southerly along said line, a distance of 19.16'; thence N 89° 46' 25" W, 311.07'; thence S 9° 31' 43" E, 69.41'; thence S 89° 56' 16" W, 506.30'; thence N 0° 01' 34" W, 97.28' to an existing fenceline; thence S 88° 33' 12" E along said fenceline, 487.64'; thence N 89° 38' 52" E along said fenceline, 318.42' to the POINT OF BEGINNING; said described parcel containing 1.17 acres, more or less. Parcel is subject to any easements of record and or usage.

**SURVEYOR'S CERTIFICATE:**

I hereby certify that I have made a survey according to the instructions and/or description furnished me and that the plat drawn is a correct representation of that survey to the best of my knowledge and belief.

*Michael R. LaRosa*  
Michael R. LaRosa RLS No. S-2259

*4/8/997*  
date

C:\D\97s-60\97s-60.DES

