

SURVEY PLAT
WOODLAND CONSULTANTS, INC.

SURVEY FOR: Ron Hasburgh

December 20, 1996
Revised January 7, 1997

Sheet 1 of 2

All that part of the Northeast Quarter (NE $\frac{1}{4}$) of the Southeast Quarter (SE $\frac{1}{4}$), that part of the Southeast Quarter (SE $\frac{1}{4}$) of the Southeast Quarter (SE $\frac{1}{4}$) and that part of the Southwest Quarter (SW $\frac{1}{4}$) of the Southeast Quarter (SE $\frac{1}{4}$) of Section 22, Township 8 North, Range 1 West, Town of Muscoda, Grant County, Wisconsin bounded and described as follows:

Commencing at the Northwest Corner of said Section 22, a stone monument with a chiseled "X"; Thence East, 3332.22 feet; Thence South, 4237.46 feet to an iron pipe, the Point of Beginning;

Thence N 36°-56'-49" E, 126.23 feet to a reinforcing bar;

Thence S 44°-55'-10" E, 209.63 feet to a reinforcing bar;

Thence N 58°-10'-41" E, 819.48 feet to the centerline of Hickory Flat Road, said point being the P.C. of a curve to the right;

Thence 35.29 feet along the arc of said curve, radius of 4300.00 feet, the center of which lies to the Southwest, chord bearing S 11°-03'-26" E, 35.29 feet to the P.T. of said curve;

Thence leaving said centerline, S 58°-10'-41" W, 982.42 feet;

Thence N 37°-19'-04" W, 179.88 feet;

Thence N 36°-56'-49" E, 34.28 feet to the Point of Beginning;

Said parcel, inclusive of a portion of the Right-of-Way of Hickory Flat Road, contains 62,849.3 square feet or 1.442 acres of land, being subject to an Easement, sixty-six feet in width, described as follows:

Commencing at the Northwest Corner of Section 22, T. 8 N., R. 2 W., Town of Muscoda, Grant County, Wisconsin; Thence East, 3332.22 feet; Thence South, 4237.46 feet to an iron pipe, lying situated on the southeasterly line of an existing easement, the Point of Beginning;

Thence S 37°-19'-04" E, 159.20 feet;

Thence N 58°-10'-41" E, 70.48 feet;

Thence N 10°-06'-37" E, 44.36 feet;

Thence N 58°-10'-41" E, 881.79 feet to the centerline of Hickory Flat Road, said point being the P.C. of a curve to the right;

Thence 70.58 feet along the arc of said curve, radius of 4300.00 feet, the center of which lies to the southwest, chord bearing S 11°-03'-26" E, 70.58 feet to the P.T. of said curve;

Thence S 58°-10'-41" W, 827.34 feet;

Thence S 10°-06'-37" W, 44.36 feet;

Thence S 58°-10'-41" W, 159.86 feet;

Thence N 37°-19'-04" W, 200.56 feet to the southeasterly line of an existing easement;

Thence N 36°-56'-49" E, 68.56 feet along said existing easement to the Point of Beginning.

I certify that I have surveyed the above described parcel of land and that the following Plat is an accurate survey and a true representation thereof and correctly shows the exterior boundary lines of said parcel and the correct measurements thereof to the best of my knowledge and belief.

Dated this 10th day of January, 1997

Richland Center, Wisconsin

Revised January 7, 1997

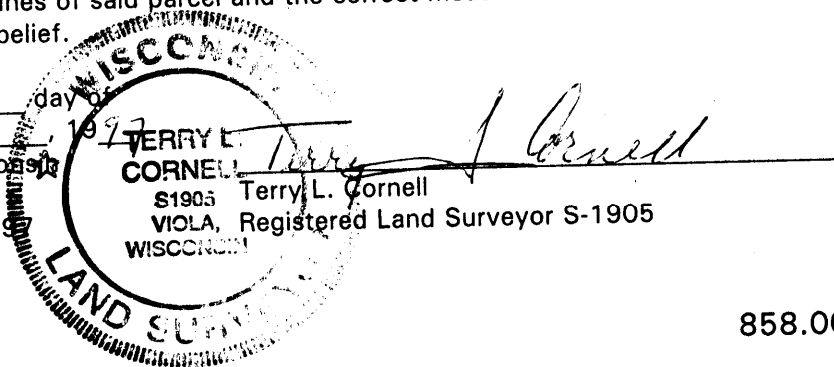

858.004