



# SURVEY PLAT

-CHANCE-PAUL  
-S3LANBLK42MSW

Of 2 parcels of land located in Block 41, Block 42, and Block 49 in the City of Lancaster, Grant County, Wisconsin, said parcels being more particularly described as follows:

### PARCEL A (TOM PAUL PARCEL)

Commencing at the Center of of the SW 1/4 of Section 3, T4N R3W of the 4th P.M., Grant County, Wisconsin;  
thence S 00deg 10min 41sec W 60.00 ft to a 3/4" iron bar marking the POINT OF BEGINNING;  
thence S 00deg 10min 41sec W 52.50 ft to a 3/4" iron bar;  
thence S 00deg 17min 22sec W 100.00 ft to a 3/4" iron bar;  
thence S 89deg 43min 00sec E 172.54 ft to a 3/4" iron bar;  
thence N 00deg 12min 40sec W 152.51 ft to a 3/4" iron bar;  
thence N 89deg 43min 00sec W 171.31 ft to the POINT OF BEGINNING,  
containing 0.602 acres, more or less, and being subject to any and all easements of record.

### PARCEL B (REMAINING CHANCE PARCEL)

Commencing at the Center of of the SW 1/4 of Section 3, T4N R3W of the 4th P.M., Grant County, Wisconsin;  
thence S 00deg 10min 41sec W 112.50 ft to a 3/4" iron bar;  
thence S 00deg 17min 22sec W 100.00 ft to a 3/4" iron bar;  
thence S 89deg 43min 00sec E 172.54 ft to a 3/4" iron bar marking the POINT OF BEGINNING;  
thence N 00deg 12min 40sec W 120.00 ft to a 3/4" iron bar;  
thence S 89deg 43min 00sec E 163.87 ft to the Westerly R.O.W. line of Taylor Street;  
thence S 00deg 34min 17sec E 20.00 ft to a 1" iron pipe;  
thence N 89deg 43min 00sec W 2.97 ft along the R.O.W. line of Taylor Street;  
thence S 00deg 17min 22sec W 100.00 ft along the Westerly line of Taylor Street;  
thence N 89deg 43min 00sec W 160.16 ft to the POINT OF BEGINNING,  
containing 0.444 acres, more or less, and being subject to any and all easements of record.

### SURVEYOR'S CERTIFICATE:

I, Larry L. Austin, Registered Wisconsin Land Surveyor, do hereby certify that the above description was surveyed, mapped, and monumented by me or under my direct supervision all in accordance with the instructions of Marvin Chance, and to the best of my knowledge and belief, this plat is an accurate representation thereof.

  
LARRY L. AUSTIN, RLS 1903  
AUSTIN ENGINEERING  
4211 S.T.H. 81 E  
LANCASTER, WI 53813  
PHONE 608-723-6363  
FAX 608-723-6702

9-5-96  
DATE  
*Revised 3-18-97*

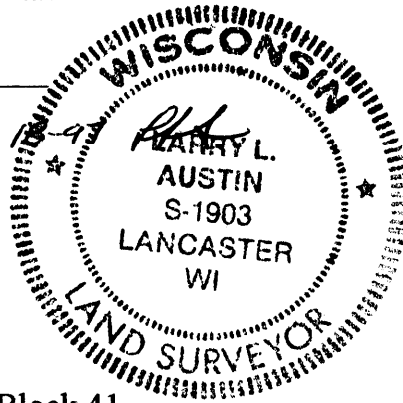

BEARING REFERENCE: Bearings referenced to the West line of Block 41- assumed to bear S 00deg 10min 41sec W.