

REC'D JUL 5 1996

Sec. T2N R1W

122
SHEET 1 OF 2

SURVEY PLAT

-FERGUSON/WILLIAM MILLER
- 2107FB9604WPPFA(m2)

Of that property as described in Volume 557 at Page 557, Grant County Registry, Lancaster, Wisconsin, being described as follows:

"A part of the Southwest Quarter (S.W. 1/4) of the Southeast Quarter (S.E. 1/4) of Section Six (6), Township Two (2) North, Range One (1) West of the 4th P.M., Grant County, Wisconsin, bounded and described as follows, to-wit: Commencing at the Northwest Corner of the S.W. 1/4 of the S.E. 1/4 of said Section 6; thence South 00 00'00" East (assumed bearing) on the West line of the S.W. 1/4 of the S.E. 1/4 of said Section 6, 479.65 feet to the point of beginning of the following described tract of land; thence South 00 00'00" East on the West line of the S.W. 1/4 of the S.E. 1/4 of said Section 6, 297.40 feet; thence South 41 52'38" East 223.72 feet to a point in the centerline of a public roadway; thence North 48 07'54" East along said centerline 194.28 feet; thence North 41 52'38" West 448.92 feet to the point of beginning, containing 1.50 acres, more or less."

SURVEYOR'S CERTIFICATE: I, Larry L. Austin, Registered Wisconsin Land Surveyor, do hereby certify that the above survey, description, and plat were prepared by me or under my direct supervision, in accordance with the instructions of William Miller, and to the best of my knowledge and belief, this plat is an accurate representation thereof.

LARRY L. AUSTIN RLS 1903
AUSTIN ENGINEERING
4211 HWY 81 E
LANCASTER, WISCONSIN 53813
PHONE 608-723-6363
FAX 608-723-6702

6/19/96
DATE

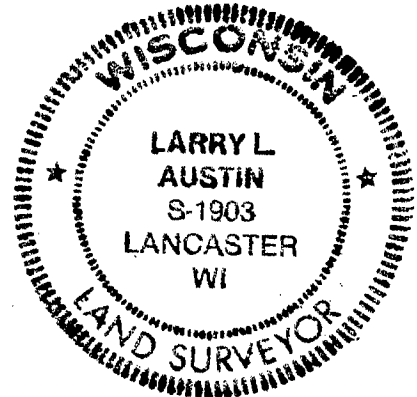

SURVEY PLAT

-WILLIAM MILLER
- 2107FB9604WPPFA(m2)

LEGEND

- ▲ NO. 6 IRON BAR FD
- △ NO. 6 x 24" IRON BAR SET
- (R=) RECORDED AS

SCALE 1" = 100'

