

SURVEY PLAT

-MITCH/DARLENE CARL
-DDHFB9504PW10

Of a parcel of land located in the Northwest 1/4 of the Northeast 1/4 of Section 14, T 5 N, R 2 W of the 4th P.M., Grant County, Wisconsin, said parcel being more particularly described as follows:

Commencing at the North 1/4 corner of Section 14, T 5 N, R 2 W of the 4th P.M., Grant County, Wisconsin; thence N 89°58'26" E 377.14' along the North line of the Northeast 1/4 of said Section 14; thence S 10°41'17" W 153.45' to the point of beginning;
 thence S 01°50'00" E 799.43' to a point in the center line of Rock School Road;
 thence S 72°59'04" W 127.54' along said center line;
 thence S 69°56'04" W 247.13' along said center line;
 thence S 66°39'08" W 17.41' along said center line to the West line of the Northeast 1/4;
 thence N 00°13'24" W 72.49' along the West line of the Northeast 1/4;
 thence N 09°04'20" E 867.34' to an existing fence corner;
 thence S 89°44'28" E 208.01' to the point of beginning, containing 5.743 acres, more or less, and being subject to any and all easements of record, including, but not limited to a 33' wide R.O.W. easement for Rock School Road as shown on the plat below, and a 20' wide ingress-egress easement, said easement being described as follows:

20' WIDE INGRESS-EGRESS EASEMENT

Commencing at the North 1/4 corner of Section 14, T 5 N, R 2 W of the 4th P.M., Grant County, Wisconsin; thence N 89°58'26" E 377.14' along the North line of the Northeast 1/4 of said Section 14; thence S 10°41'17" W 153.45'; thence S 01°50'00" E 799.43' to a point in the center line of Rock School Road; thence S 72°59'04" W 127.54' along said center line; thence S 69°56'04" W 247.13' along said center line; thence S 66°39'08" W 81.31' along said center line to the point of beginning;
 thence N 24°47'01" W 122.22';
 thence N 13°34'44" W 52.09';
 thence N 21°59'26" E 49.66';
 thence N 40°57'17" E 62.69';
 thence N 46°50'21" E 150.00' to the terminus point.

SURVEYOR'S CERTIFICATE: I, Larry L. Austin, Registered Wisconsin Land Surveyor, do hereby certify that the above survey, description, and plat were prepared by me or under my direct supervision, in accordance with the instructions of Mitch and Darlene Carl, and to the best of my knowledge and belief, this plat is an accurate representation thereof.

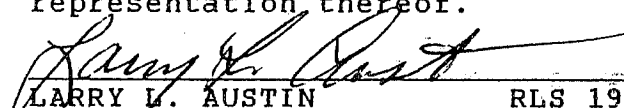

 LARRY L. AUSTIN RLS 1903
 LARRY AUSTIN ENGINEERING
 RT.2
 LANCASTER, WI 53813
 PHONE (608) 723-6363

9/28/95
 DATE

BEARING REFERENCE: For purposes of this survey bearings are referenced to the North line of the Northeast 1/4 of said Section 14 which is assumed to bear N 89°58'26" E.

WAIVER OF MONUMENTATION

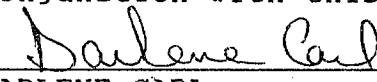
I, Darlene Carl, do hereby request that no monuments be set in conjunction with this description at this time.

X 
 DARLENE CARL

X 9-28-95
 DATE

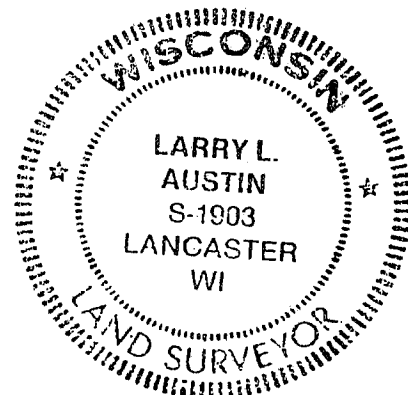

SURVEY PLAT

- CARL
- DDHFB9504PW10

LEGEND

- 3/4" IRON BAR FOUND
- ▲ RAILROAD SPIKE FOUND
- *-* EXISTING FENCE



N 1/4 COR. SEC. 14 T5N, R2W
4TH P.M., GRANT CO., WIS.

