

REC'D OCT 5 1995

SURVEY PLAT

115

-JOHN BAXTER
-DD1AFB9510PW10

Of a parcel of land located in the SE 1/4 of Section 2, T 4 N, R 1 W of the 4th P.M., Grant County, Wisconsin, and being more particularly described as follows:

Commencing at the NE corner of Lot 13, Block E, Plan of the Town of Washburn, Grant County, Wisconsin,
 thence S 00°29'05" W 120.00' along the East of said Lot 13 and it's extension thereof;
 thence N 89°33'46" E 34.63' to the center line of S.T.H. 80;
 thence Southwesterly along said center line 135.50' on the arc of a curve concave Westerly having a radius of 1910.00' and a long chord which bears S 01°35'44" W 135.47';
 thence N 78°57'41" W 181.63' along a line of a 1978 Survey by Laurence Schmit;
 thence N 09°39'59" E 153.30' along an Easterly line of said Survey;
 thence N 12°00'39" E 10.50' to the Southwest corner of Lot 13, Block E, Plan of the Town of Washburn;
 thence N 00°29'05" E 60.00' along the West line of said Lot 13;
 thence S 89°30'55" E 120.00' along the North line of said Lot 13 to the point of beginning, containing 0.810 acres, more or less, and being subject to any and all easements of record, including, but not limited to a R.O.W. for S.T.H. 80, as shown on the attached plat;

SURVEYOR'S CERTIFICATE: I, Larry L. Austin, Registered Wisconsin Land Surveyor do hereby certify that the above survey, description, and plat were prepared by me or under my direct supervision, in accordance with the instructions of Attorney John Baxter, to the best of my knowledge and belief, this plat is an accurate representation thereof.

Larry L. Austin
 LARRY L. AUSTIN RLS 1903
 LARRY AUSTIN ENGINEERING A
 RT. 2
 LANCASTER, WI 53813
 PHONE (608) 723-6363

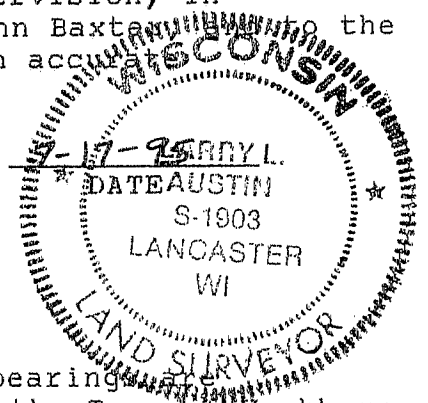

BEARING REFERENCE: For purposes of this survey bearing referenced to the East line of Block E, Plan of the Town of Washburn, which is assumed to bear S 00°29'05" W

