

REC'D SEP 21 1995

SURVEY PLAT

-THOMAS GENTHE
-DDCFB9410PW5

102

Of a parcel of land located in part of Block 51 of the Assessment Plat and part of Block III H.S. Rountree Addition, City of Platteville, Grant County, Wisconsin, said parcel being more particularly described as follows:

Commencing at the NW Corner of Block III, H.S. Rountree Addition to the Village (now City) of Platteville, Grant County, Wisconsin, thence N 71°51'48" E 140.00' along the South line of Dewey Street to the point of beginning;
thence N 71°51'48" E 128.49' along said South line;
thence S 17°41'40" E 46.52';
thence S 05°16'28" W 23.99';
thence S 17°55'22" E 73.11' to the Northerly line of Lot 48, Covells Addition;
thence S 72°35'42" W 125.24' to the Northwesterly corner of said Lot 48;
thence N 20°02'44" E 4.89';
thence N 15°14'51" W 82.15';
thence N 18°23'27" W 54.18' to the point of beginning containing 17,420 s.f., more or less, and being subject to any and all easements of record.

SURVEYOR'S CERTIFICATE: I, Larry L. Austin, Registered Wisconsin Land Surveyor do hereby certify that the above survey, plat, and description were prepared by me or under my direct supervision, in accordance with the instructions of Thomas Genthe, and to the best of my knowledge and belief this plat is an accurate representation thereof.

Larry L. Austin
LARRY L. AUSTIN RLS 1903
LARRY AUSTIN ENGINEERING
RT. 2
LANCASTER, WI. 53813
PHONE (608) 723-6363

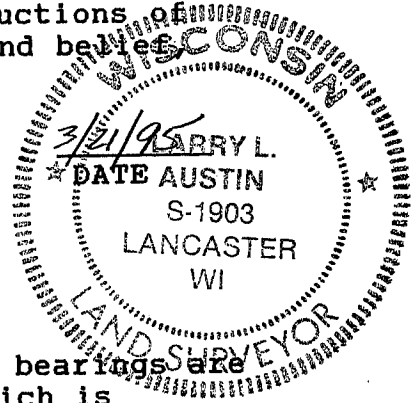

BEARING REFERENCE: For purposes of this survey, bearings are referenced to the South line of Dewey Street, which is assumed to bear N 71°51'48" E.

LEGEND

- 2" IRON BAR FOUND
- 1/4" IRON PIPE FOUND
- 1" IRON PIPE FOUND
- 1" x 24" IRON PIPE SET
- () REC. DIM OR BRG.
- ▲ 1" SOLID IRON ROD FND.

SCALE 1"=50'
N
LANCASTER ST. (S.T.H. #81)

