

REC'D SEP 21 1995

98

# PLAT OF SURVEY

-GARY BRINKMAN  
-DDGFB9507PW7

Being a survey establishing the Northwest corner of the Southeast 1/4 of the Northeast 1/4 and points on the North line of the Southeast 1/4 of the NE 1/4 of Section 33, T 3 N, R 4 W, of the 4th P.M., Grant County, Wisconsin.

SURVEYOR'S CERTIFICATE: I, Larry L. Austin, Registered Wisconsin Land Surveyor do hereby certify that the above survey and plat were prepared by me or under my direct supervision, in accordance with the instructions of Gary Brinkman, and to the best of my knowledge and belief, this plat is an accurate representation thereof.

*Larry L. Austin*  
LARRY L. AUSTIN RLS 1903  
LARRY AUSTIN ENGINEERING  
RT. 2  
LANCASTER, WI 53813  
PHONE (608) 723-6363

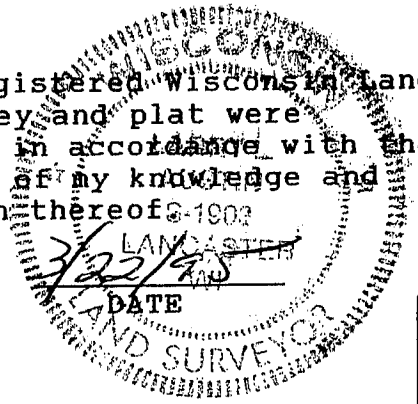

BEARING REFERENCE: For purposes of this survey bearings are referenced to the North line of the NE 1/4 of Section 33 which is assumed to bear N 89°25'56" W

### LEGEND

SCALE 1" = 400'

- ⊙ GRANT CO. ALUM. MON. FND
- 2" IRON PIPE FND
- ▲ 5/8" IRON BAR FND
- ⊙ 1 1/4" IRON PIPE FND.
- 1" IRON PIPE FND.
- 1" x 24" IRON PIPE SET

