

SURVEY PLAT

SHEET 1 OF 2

RECD AUG 29 1995

- BOB CLARE
DDGFB9417 PW6

OF A PARCEL OF LAND LOCATED IN THE SE 1/4 OF THE SE 1/4 OF SECTION 24, T 3 N, R 1 W OF THE 4TH P.M., GRANT COUNTY, WISCONSIN, AND BEING MORE PARTICULARLY DESCRIBED AS FOLLOWS:

COMMENCING AT THE S 1/4 CORNER OF SECTION 24, T 3 N, R 1 W OF THE 4TH P.M., GRANT COUNTY, WISCONSIN, THENCE S 88°51'26" E 1331.15' TO THE SOUTHWEST CORNER OF THE SE 1/4 OF THE SE 1/4 OF SAID SECTION, SAID CORNER BEING THE POINT OF BEGINNING;
THENCE S 88°51'26" E 616.00' ALONG THE SOUTH LINE OF THE SE 1/4 OF SAID SECTION;
THENCE N 01°29'32" E 158.03';
THENCE N 00°43'56" W 160.65';
THENCE N 81°39'22" W 220.95';
THENCE N 88°51'26" W 399.41' TO THE WEST LINE OF THE SE 1/4 OF THE SE 1/4 OF SAID SECTION;
THENCE S 00°00'05" E 346.36' ALONG SAID LINE TO THE POINT OF BEGINNING CONTAINING 4.848 ACRES, MORE OR LESS, AND BEING SUBJECT TO ANY AND ALL EASEMENTS OF RECORD, INCLUDING, BUT NOT LIMITED TO A 33' WIDE R.O.W. EASEMENT FOR COLLEGE FARM ROAD, SAID EASEMENT BEING LOCATED NORTHERLY OF AND ADJACENT TO THE SOUTH LINE OF THE ABOVE DESCRIBED PARCEL.

SURVEYOR'S CERTIFICATE: I, LARRY L. AUSTIN, REGISTERED WISCONSIN LAND SURVEYOR DO HEREBY CERTIFY THAT THE ABOVE SURVEY, DESCRIPTION, AND PLAT WERE PREPARED BY ME OR UNDER MY DIRECT SUPERVISION, IN ACCORDANCE WITH THE INSTRUCTIONS OF ROBERT CLARE, AND TO THE BEST OF MY KNOWLEDGE AND BELIEF, THIS PLAT IS AN ACCURATE REPRESENTATION THEREOF.

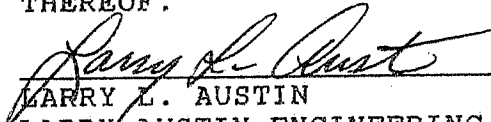
LARRY L. AUSTIN RLS 1903
LARRY AUSTIN ENGINEERING
RT.2
LANCASTER, WI 53813
PHONE (608) 723-6363

11/27/94
DATE

BEARING REFERENCE: FOR PURPOSES OF THIS SURVEY BEARINGS ARE REFERENCED TO THE SOUTH LINE OF THE SE 1/4 OF SECTION 24, WHICH IS ASSUMED TO BEAR S 88 51'26" E.

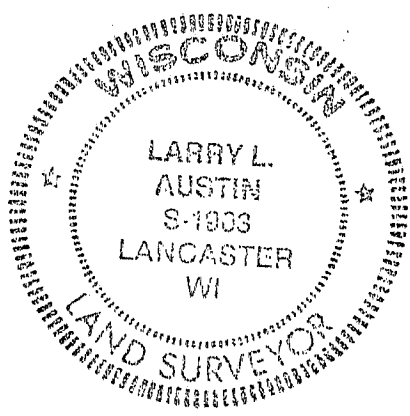

SURVEY PLAT

- BOB CLARE
- DDGFB9417PW6



SCALE 1" = 100'

LEGEND

- ⊙ ALUMINUM MON. FOUND
- 7/8" IRON BAR FOUND
- 1" x 24" IRON PIPE SET
- ✕✕ EXISTING FENCE
- 1" IRON BAR FOUND
- 1" x 24" SOLID ROUND BAR SET

N 00° 43' 56" W - 160.65'

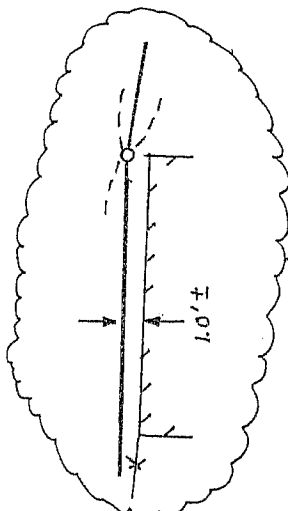

N 88° 51' 26" W - 399.41'

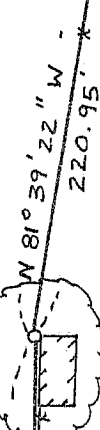

W 81° 39' 22" W - 220.95'

4.848 ACRES ±

N 01° 29' 32" E - 158.03'

FARM ROAD

COLLEGE

616.00'

WEST LINE, SE 1/4, SE 1/4

S 00° 00' 05" E - 346.36'

P.O.B. - SW COR., SE 1/4, SE 1/4

S 88° 51' 26" E

S 88° 51' 26" E - 1331.15'

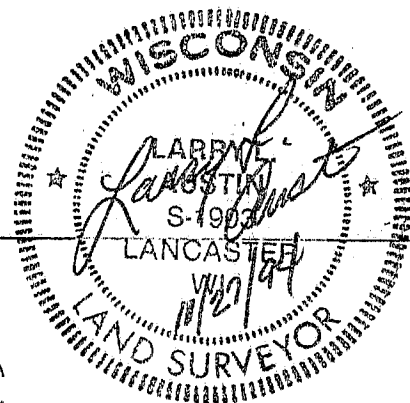

S 1/4 SECTION 24, T3N,
R1W; 4TH P.M., GRANT CO., WI

