

ANCHMARK SURVEYS OF SW. WIS., INC.

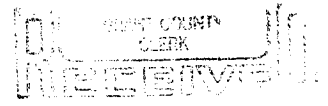

133 North Central Avenue, P.O. Box 486, Richland Center, WI 53581
(608) 647-8533

APR 25 1995

CORRECTIVE DESCRIPTION FOR: KEN LAWVER

All that part of the Northeast One-quarter and Southeast One-quarter of the Northwest One-quarter of Section 16, Township 8 North, Range 2 West, Town of Watterstown, Grant County, Wisconsin, bounded and described as follows:

Commencing at the Northwest corner of Section 16; thence East, along the North line of Section 16, 1598.30 feet; thence South, perpendicular to said North line, 1138.12 feet to a point on the centerline of Old "C" and the place of beginning of the parcel hereinafter described; thence South $50^{\circ} 03' 36''$ East 600.92 feet; thence South $56^{\circ} 31' 55''$ West 260.72 feet; thence North $44^{\circ} 42' 29''$ West 537.52 feet to a point in the centerline of "OLD C"; thence North $42^{\circ} 26' 06''$ East, along said centerline, 200.00 feet to the place of beginning, containing 128,779 square feet or 2.956 acres of land.

SUBJECT TO: a strip of land 33 feet in width lying South of and adjacent to the above described centerline of Old "C" for Town Road Purposes.

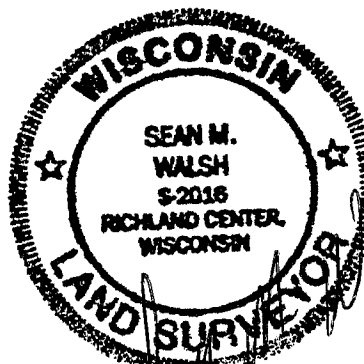

SEAN M.
WALSH
S-2016
RICHLAND CENTER,
WISCONSIN

Sean M. Walsh

MARCH 17, 1995