

REC'D FEB 15 1995

SHT 1 OF 2

PLAT OF SURVEY

-DIGMAN-

26

FB9404DDZ1 PWS

OF A PARCEL OF LAND LOCATED IN THE SE 1/4 AND THE NE 1/4 OF SECTION 28, T 3 N, R 1 W OF THE 4TH P.M., GRANT COUNTY, WISCONSIN, AND BEING MORE PARTICULARLY DESCRIBED AS FOLLOWS:

COMMENCING AT THE E 1/4 CORNER OF SECTION 28, T 3 N, R 1 W OF THE 4TH P.M., GRANT COUNTY, WISCONSIN, THENCE N 89° 08' 09" W 669.90' ALONG THE E-W 1/4 LINE; THENCE S 00° 51' 51" W 10.96 FEET TO THE NW CORNER OF THAT PROPERTY DESCRIBED IN VOLUME 634 PAGE 480, GRANT COUNTY REGISTRY, SAID CORNER BEING THE POINT OF BEGINNING;

THENCE N 80° 06' 32" W 783.68' TO A 1" IRON PIPE;

THENCE S 11° 41' 55" W 515.27';

THENCE S 84° 16' 56" E 146.36' TO A 1" IRON PIPE;

THENCE N 84° 19' 29" E 735.90' TO THE SW CORNER OF THAT

PROPERTY DESCRIBED IN SAID VOLUME 634 AT PAGE 480;

THENCE N 00° 04' 37" W 311.66' TO THE POINT OF BEGINNING, CONTAINING 8.013 ACRES, MORE OR LESS, AND BEING SUBJECT TO ANY AND ALL EASEMENTS OF RECORD, INCLUDING, BUT NOT LIMITED TO THE FOLLOWING INGRESS-EGRESS EASEMENT AND FIELD ACCESS EASEMENT, SAID EASEMENTS BEING DESCRIBED AS FOLLOWS:

INGRESS-EGRESS EASEMENT (C.T.H. "D" TO THE PROPERTY) EASE. #1

A 30' WIDE PARCEL OF LAND THE CENTER LINE OF WHICH IS DESCRIBED AS FOLLOWS: COMMENCING AT THE E 1/4 CORNER OF SECTION 28, T 3 N, R 1 W OF THE 4TH P.M., GRANT COUNTY, WISCONSIN, SAID CORNER BEING THE POINT OF BEGINNING;

THENCE S 85° 36' 35" W 52.95';

THENCE N 89° 47' 28" W 476.74';

THENCE S 88° 41' 11" W 155.59' TO THE TERMINUS POINT;

FIELD ACCESS EASEMENT (THROUGH THE PROPERTY) EASE. #2

A 30' WIDE PARCEL OF LAND THE CENTER LINE OF WHICH IS DESCRIBED AS FOLLOWS: COMMENCING AT THE E 1/4 CORNER OF SECTION 28, T 3 N, R 1 W OF THE 4TH P.M., GRANT COUNTY, WISCONSIN; THENCE N 85° 36' 35" W 52.95'; THENCE N 89° 47' 28" W 476.74' TO THE POINT OF BEGINNING;

THENCE S 88° 41' 11" W 155.59';

THENCE S 71° 27' 57" W 181.60';

THENCE S 74° 07' 26" W 78.07';

THENCE S 84° 46' 32" W 102.52';

THENCE S 88° 58' 09" W 192.60';

THENCE S 84° 29' 36" W 103.63';

THENCE N 38° 14' 05" W 49.09';

THENCE N 07° 32' 01" W 94.86';

THENCE N 81° 51' 52" W 70.55';

THENCE S 43° 07' 17" W 100.00' TO THE TERMINUS POINT.

SURVEYOR'S CERTIFICATE: I, LARRY L. AUSTIN, REGISTERED WISCONSIN LAND SURVEYOR DO HEREBY CERTIFY THAT THE ABOVE SURVEY, DESCRIPTION, AND PLAT WERE PREPARED BY ME OR UNDER MY DIRECT SUPERVISION, IN ACCORDANCE WITH THE INSTRUCTIONS OF JAY DIGMAN, AND TO THE BEST OF MY KNOWLEDGE AND BELIEF, THIS PLAT AND SURVEY ARE AN ACCURATE REPRESENTATION THEREOF.

Larry L. Austin
LARRY L. AUSTIN

RLS 1903

9/11/94
DATE

LARRY AUSTIN ENGINEERING
RT.2
LANCASTER, WI 53813
PHONE (608) 723-6363

BEARING REFERENCE: FOR PURPOSES OF THIS SURVEY BEARINGS ARE REFERENCED TO THE EAST-WEST 1/4 LINE OF SECTION 28, WHICH IS ASSUMED TO BEAR N 89° 08' 09" W.

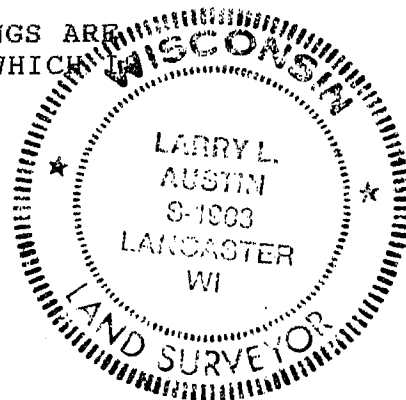

SURVEY PLAT

- DIGMAN
- FB 9404 DD21 PW6

E 1/4 COR., SEC 28, T3N
R1W, 4TH P.M., GRANT CO.,
WISC

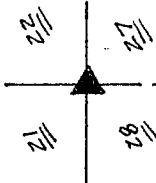

SCALE 1" = 100'

LEGEND

- 2" IRON PIPE FOUND
- ▲ RAILROAD SPIKE FOUND
- 1" x 24" IRON PIPE SET
- 3/4" BAR

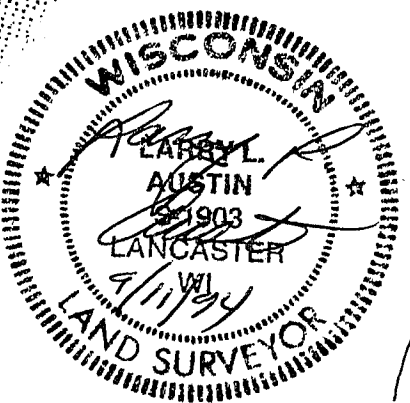

TABULATION OF EASEMENT LINES

- (A) N 89° 47' 28" W - 476.74'
- (B) S 88° 41' 11" W - 155.59'
- (C) S 71° 27' 57" W - 181.60'
- (D) S 74° 07' 26" W - 78.07'
- (E) S 84° 46' 32" W - 102.52'
- (F) S 88° 58' 09" W - 192.60'
- (G) S 84° 29' 36" W - 103.63'
- (H) N 38° 14' 05" W - 49.09'
- (I) N 07° 32' 01" E - 94.86'
- (J) N 81° 51' 52" W - 70.55'
- (K) S 43° 07' 17" W - 75.28'
- (L) S 85° 36' 35" W - 52.95'

