

SURVEY PLAT

25

- HINDERMAN
- DD 8 FB 9411 PW6

Of a parcel of land located in the East 1/2 of the SW 1/4 and the West 1/2 of the SE 1/4 of Section 32, T 2 N, R 1 W of the 4th P.M., Grant County, Wisconsin, and being more particularly described as follows:

Commencing at the S 1/4 corner of Section 32, T 2 N, R 1 W of the 4th P.M., Grant County, Wisconsin, said corner being the point of beginning;
 thence N 89° 57' 22" W 1322.42' to the SW corner of the East 1/2 of the SW 1/4 of said section;
 thence N 00° 04' 39" E 2436.86' along the West line of the E 1/2 of the SW 1/4 of said section to the SW corner of that property described in Volume 548 at Page 186, Grant County Registry;
 thence N 89° 49' 22" E 208.70' to the SE corner of said property;
 thence N 00° 10' 38" W 208.70' to the E-W 1/4 line of said section;
 thence N 89° 49' 22" E 2433.82' along said E-W 1/4 line to the NE corner of the W 1/2 of the SE 1/4 of said section;
 thence S 00° 00' 27" W 1339.03' along the East line of the W 1/2 of the SE 1/4 of said section;
 thence S 89° 43' 13" W 1321.27' to a point on the West line of the SE 1/4 of said section;
 thence S 00° 03' 27" W 1309.27' along said west line to the point of beginning containing 120.000 acres, more or less, and being subject to any and all easements of record including but not limited to R.O.W.'s for Model Road and Hill Road as shown on the attached plat.

SURVEYOR'S CERTIFICATE: I, Larry L. Austin, Registered Wisconsin Land Surveyor do hereby certify that the above survey, description, and plat were prepared by me or under my direct supervision, in accordance with the instructions of Vern Vosberg, and to the best of my knowledge and belief, this plat is an accurate representation thereof.

Larry L. Austin
 LARRY L. AUSTIN RLS 1903
 LARRY AUSTIN ENGINEERING
 RT. 2
 LANCASTER, WI 53813
 PHONE (608) 723-6363

2-1-95
 DATE

BEARING REFERENCE: For purposes of this survey bearings are referenced to the South line of the SW 1/4 of section 32 which is assumed to bear N 89° 57' 22" W.

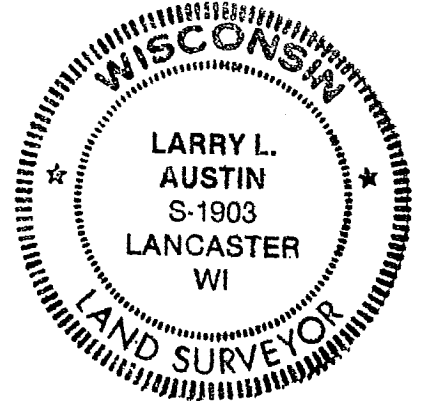

LEGEND

- 1" IRON PIPE FOUND
- 3/4" IRON BAR FOUND
- 3/4" x 24" IRON BAR SET
- GRANT COUNTY AL. MON. SET
- 1" x 24" IRON PIPE SET

SCALE 1" = 400'

