

121

REC'D JAN 5 1995

SURVEY PLAT

SHEET 1 OF 2

FAHERTY
DDGFB9419LW

OF 2 PARCELS OF LAND LOCATED IN SW 1/4 OF SECTION 11, T 3 N, R 1 W OF THE 4TH P.M., GRANT COUNTY, WISCONSIN BEING MORE PARTICULARLY DESCRIBED AS FOLLOWS:

PARCEL 1

COMMENCING AT THE W 1/4 CORNER OF SECTION 11, T 3 N, R 1 W OF THE 4TH P.M., GRANT COUNTY, WISCONSIN, THENCE S 89°37'51" E 1626.69'; THENCE S 01°08'58" E 1606.95' TO A FOUND 1" IRON PIPE MARKING THE NORTHEAST CORNER OF THAT PROPERTY DESCRIBED IN VOLUME 734 AT PAGE 789, GRANT COUNTY REGISTRY, LANCASTER, WI, SAID PIPE BEING THE POINT OF BEGINNING;

THENCE S 88°51'02" W 113.00' ALONG THE NORTH LINE OF SAID PROPERTY;

THENCE S 01°08'58" E 269.37' ALONG THE WEST LINE OF SAID PROPERTY;

THENCE S 88°51'02" W 115.00';

THENCE N 01°08'58" W 301.08';

THENCE N 88°51'02" E 228.00';

THENCE S 01°08'58" E 31.71' TO THE POINT OF BEGINNING, CONTAINING 0.877 ACRES, MORE OR LESS, AND BEING SUBJECT TO ANY AND ALL EASEMENTS OF RECORD.

PARCEL 2

COMMENCING AT THE W 1/4 CORNER OF SECTION 11, T 3 N, R 1 W OF THE 4TH P.M., GRANT COUNTY, WISCONSIN, THENCE S 89°37'51" E 1626.69'; THENCE S 01°08'58" E 1606.95' TO A FOUND 1" IRON PIPE MARKING THE NORTHEAST CORNER OF THAT PROPERTY DESCRIBED IN VOLUME 734 AT PAGE 789, GRANT COUNTY REGISTRY, LANCASTER, WI.; THENCE S 88°51'02" W 113.00' ALONG THE NORTH LINE OF SAID PROPERTY; THENCE S 01°08'58" E 269.37' ALONG THE WEST LINE OF SAID PROPERTY TO THE POINT OF BEGINNING;

THENCE S 88°51'02" W 115.00';

THENCE S 01°08'58" E 25.00' TO THE NORTHWEST CORNER OF THAT PROPERTY DESCRIBED IN VOLUME 658 AT PAGE 603, GRANT COUNTY REGISTRY;

THENCE N 88°51'02" E 115.00' TO THE NORTHEAST CORNER SAID PROPERTY;

THENCE N 01°08'58" W 25.00' TO THE POINT OF BEGINNING, CONTAINING 0.066 ACRES, MORE OR LESS, AND BEING SUBJECT TO ANY AND ALL EASEMENTS OF RECORD.

SURVEYOR'S CERTIFICATE: I, LARRY L. AUSTIN, REGISTERED WISCONSIN LAND SURVEYOR, DO HEREBY CERTIFY THAT THIS SURVEY, DESCRIPTION AND PLAT WERE PREPARED BY ME OR UNDER MY DIRECT SUPERVISION, AT THE DIRECTION OF RALPH FAHERTY, AND TO THE BEST OF MY KNOWLEDGE AND BELIEF IS AN ACCURATE REPRESENTATION THEREOF.

Larry L. Austin
LARRY L. AUSTIN
LARRY AUSTIN ENGINEERING
4211 HWY 81 E
LANCASTER, WI 53813
PHONE 608-723-6363

4/28/94
DATE

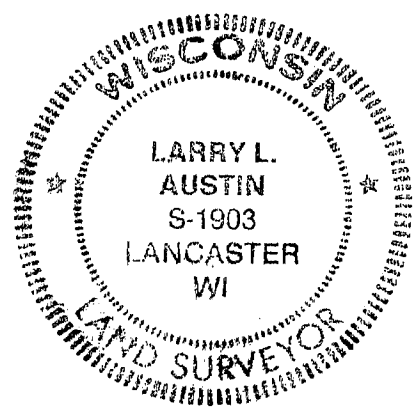

SURVEY PLAT *

- FAHERTY
- DDGFB9419

*NOTE: LINES OF THIS SURVEY BASED ON
RETRACEMENT OF A SURVEY BY D.C. DIXON
IN 1974.

LEGEND

- ▲ P.K. NAIL FOUND
- 1 1/4" IRON BAR FOUND
- 1" IRON PIPE FOUND
- 1" x 24" IRON PIPE SET
- *** EXISTING FENCE
- () REC. DIM. OR BRG.

BEARING REFERENCE: FOR PURPOSES OF
THIS SURVEY BEARINGS ARE REFERENCED
TO THE E-W 1/4 LINE OF SEC. 11,
ASSUMED BRG = S89°37'51"E

