

SURVEY PLAT

- GEORGE EDGE  
- DDCFB9411PW6

105

OF A PARCEL OF LAND LOCATED IN NE 1/4 OF SECTION 14, T 5 N, R 4 W OF THE 4TH P.M., GRANT COUNTY, WISCONSIN, AND BEING MORE PARTICULARLY DESCRIBED AS FOLLOWS:

COMMENCING AT THE NE CORNER OF SECTION 14, T 5 N, R 4 W OF THE 4TH P.M., GRANT COUNTY, WISCONSIN, THENCE S 01°18'41" E 1910.82' ALONG THE EAST LINE OF SAID SECTION 14; THENCE S 88°41'19" W 557.44' TO A POINT IN THE CENTER LINE OF MEADOWBROOK LANE, SAID POINT BEING THE POINT OF BEGINNING;

THENCE SOUTHWESTERLY 67.35' ALONG SAID CENTER LINE ON THE ARC OF A CURVE CONCAVE NORTHWESTERLY HAVING A RADIUS OF 71.00' AND A LONG CHORD WHICH BEARS S 44°49'31" W 64.85';

THENCE S 71°00'37" W 164.27' ALONG SAID CENTER LINE;

THENCE SOUTHWESTERLY 108.90' ALONG SAID CENTER LINE ON THE ARC OF A CURVE CONCAVE SOUTHEASTERLY HAVING A RADIUS OF 99.58' AND A LONG CURVE WHICH BEARS S 39°40'44" W 103.56';

THENCE S 08°20'51" W 444.04' ALONG SAID CENTER LINE;

THENCE N 85°28'44" E 175.30';

THENCE N 25°35'51" E 280.64';

THENCE S 84°00'52" E 47.71';

THENCE N 13°44'56" E 234.87';

THENCE N 27°46'32" W 145.14' TO THE POINT OF BEGINNING CONTAINING 3.311 ACRES, MORE OR LESS, AND BEING SUBJECT TO ANY AND ALL EASEMENTS OF RECORD, INCLUDING, BUT NOT LIMITED TO A 33' WIDE R.O.W. EASEMENT FOR MEADOWBROOK LANE SAID R.O.W. BEING LOCATED SOUTHERLY AND EASTERLY OF THE NORTHERLY AND WESTERLY LINES OF THE ABOVE DESCRIBED PARCEL AS SHOWN ON THE ATTACHED PLAT.

SURVEYOR'S CERTIFICATE: I, LARRY L. AUSTIN, REGISTERED WISCONSIN LAND SURVEYOR DO HEREBY CERTIFY THAT THE ABOVE SURVEY, DESCRIPTION, AND PLAT WERE PREPARED BY ME OR UNDER MY DIRECT SUPERVISION, IN ACCORDANCE WITH THE INSTRUCTIONS OF DUANE ROWE, AND TO THE BEST OF MY KNOWLEDGE AND BELIEF, THIS PLAT IS AN ACCURATE REPRESENTATION THEREOF.

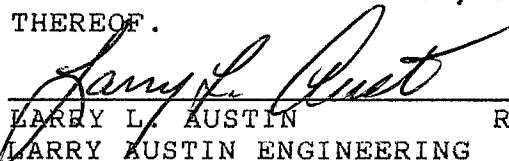
  
LARRY L. AUSTIN RLS 1903  
LARRY AUSTIN ENGINEERING  
RT. 2  
LANCASTER, WI 53813  
PHONE (608) 723-6363

10-2-94  
DATE

BEARING REFERENCE: FOR PURPOSES OF THIS SURVEY BEARINGS ARE REFERENCED TO THE EAST LINE OF THE NORTHEAST 1/4 OF SECTION 14, WHICH IS ASSUMED TO BEAR S 01°18'41" E.



# SURVEY PLAT

- GEORGE EDGE  
- DDCFB9411PW6

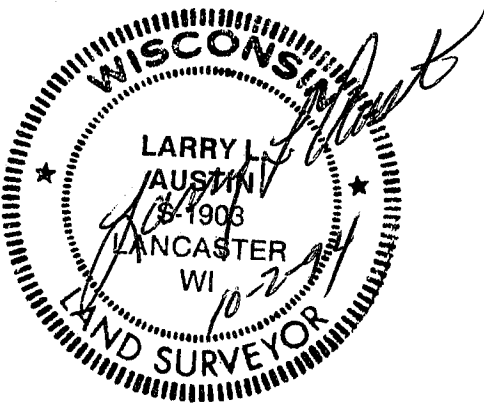

NE COR. SEC. 14, T5N  
R4W, 4TH PM. GRANT CO., WI

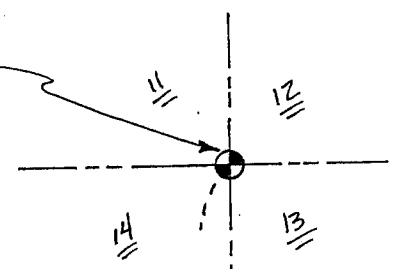

S 01° 18' 41" E - 1910.82'

S 88° 41' 19" W - 557.44'

P.O.B.

L.C. = S 44° 49' 31" W - 64.85'  
RADIUS = 71.00'

S 71° 00' 37" W - 164.27'

LANE

ARC = 108.90'  
L.C. = S 39° 40' 44" W - 103.56'  
RADIUS = 99.58'

N 27° 46' 32" W - 145.14'

3.311 ACRES ±

N 13° 44' 56" E - 234.87'

S 08° 20' 51" W - 444.04'

MEADOWBROOK

N 25° 35' 51" E - 280.64'  
S 84° 00' 52" E - 47.71'

N 85° 28' 44" E - 175.30'

SCALE 1" = 100'

N

EAST LINE OF THE NE 1/4 SEC. 14

## LEGEND

- ⊕ GRANT COUNTY ALUM. MON. FOUND
- ▲ PK NAIL FOUND IN CONCRETE OF 4.5" DIAMETER PIPE POST
- 1" x 24" IRON PIPE SET
- \*-\* EXISTING FENCE

