

# PLAT OF SURVEY\*

OF A PARCEL OF LAND LOCATED IN LOT 7, PART LOT 6 AND PART OF THE ALLEY BETWEEN LOTS 6 AND 7, ALL IN THE VILLAGE OF BEETOWN, ACCORDING TO THE RECORDED PLAT THEREOF, BEING IN THE NE 1/4 OF SECTION 30, T 4 N, R 4 W OF THE 4TH P.M., GRANT COUNTY, WISCONSIN, AND BEING MORE PARTICULARLY DESCRIBED AS FOLLOWS:

COMMENCING AT A FOUND 1" IRON PIPE MARKING THE SOUTHWEST CORNER OF LOT 7, PLAT OF THE VILLAGE OF BEETOWN, GRANT COUNTY, WISCONSIN, SAID PIPE BEING THE POINT OF BEGINNING;  
THENCE N 63° 07' 04" E 264.00' TO A FOUND 1" IRON PIPE MARKING THE SE CORNER OF LOT 7;  
THENCE N 19° 50' 43" W 105.33' TO A FOUND 1" IRON PIPE MARKING THE NE CORNER OF LOT 7;  
THENCE S 56° 30' 38" W 72.56' ALONG THE NORTH LINE OF LOT 7 TO A 1" IRON PIPE;  
THENCE N 60° 55' 25" W 39.21' ALONG AN EXISTING FENCE TO A 1" IRON PIPE;  
THENCE S 43° 31' 58" W 99.85' ALONG AN EXISTING FENCE TO A 1" IRON PIPE SET AT A FENCE CORNER;  
THENCE S 54° 47' 56" W 79.65' TO A 1" IRON PIPE AT THE SOUTHWEST CORNER OF LOT 6;  
THENCE S 20° 04' 20" E 10.28' TO A FOUND 1" IRON PIPE MARKING THE NW CORNER OF LOT 7;  
THENCE S 20° 04' 20" E 74.00' ALONG THE WEST LINE OF LOT 7 TO THE POINT OF BEGINNING CONTAINING 0.620 ACRES, MORE OR LESS, AND BEING SUBJECT TO ANY AND ALL EASEMENTS OF RECORD.

SURVEYOR'S CERTIFICATE: I, LARRY L. AUSTIN, REGISTERED WISCONSIN LAND SURVEYOR DO HEREBY CERTIFY THAT THE ABOVE SURVEY, DESCRIPTION, AND PLAT WERE PREPARED BY ME OR UNDER MY DIRECT SUPERVISION, IN ACCORDANCE WITH THE INSTRUCTIONS OF THOMAS STRAKELJAHN, AND TO THE BEST OF MY KNOWLEDGE AND BELIEF, THIS PLAT IS AN ACCURATE REPRESENTATION THEREOF.

*Larry L. Austin*  
LARRY L. AUSTIN RLS 1903  
LARRY AUSTIN ENGINEERING  
RT. 2 LANCASTER, WI 53813  
PHONE (608) 723-6363.  
BEARING REFERENCE: FOR PURPOSES OF THIS SURVEY BEARINGS ARE REFERENCED TO THE NORTH LINE OF THE NE 1/4 OF SECTION 30, WHICH ASSUMED TO BEAR N 89° 05' 51" W

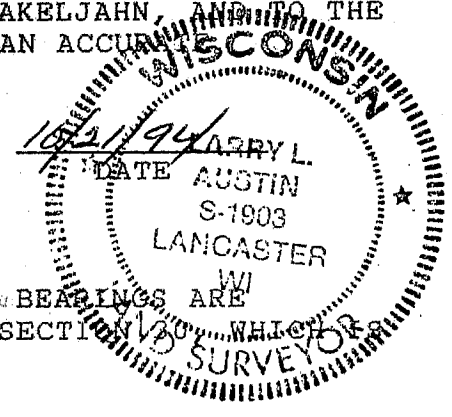

\*PARTS OF THIS SURVEY & DESCRIPTION FOLLOW OCCUPATION LINES.

