

# SURVEY PLAT

REC'D OCT 18 1994

- ROD TAYLOR  
- PDEFB9415PW

*P*

OF THE SW 1/4 OF THE SW 1/4 OF SECTION 17, T 5 N, R 3 W OF THE 4TH P.M., GRANT COUNTY, WISCONSIN.

SURVEYOR'S CERTIFICATE: I, LARRY L. AUSTIN, REGISTERED WISCONSIN LAND SURVEYOR, DO HEREBY CERTIFY THAT THIS SURVEY WAS PERFORMED BY ME OR UNDER MY DIRECT SUPERVISION, AT THE DIRECTION OF ROD TAYLOR, AND TO THE BEST OF MY KNOWLEDGE AND BELIEF, THIS PLAT IS AN ACCURATE REPRESENTATION THEREOF.

*Larry L. Austin*  
LARRY L. AUSTIN RLS 1903  
LARRY AUSTIN ENGINEERING  
RT. 2  
LANCASTER, WI. 53813  
PHONE (608) 723-6363

*8/30/94*  
DATE

BEARING REFERENCE: FOR PURPOSES OF THIS SURVEY BEARINGS ARE REFERENCED TO THE SOUTH LINE OF THE SW 1/4 OF SECTION 17, WHICH IS ASSUMED TO BEAR N 89°21'43" W.

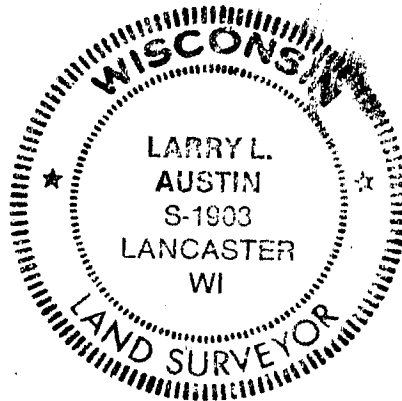

## LEGEND

- 1" x 24" IRON PIPE SET
- ALUMINUM MONUMENT SET

