

PLAT OF SURVEY

ROOP - SHERWIN

OF A PARCEL OF LAND LOCATED IN BLOCK 3 OF THE ASSESSMENT PLAT OF THE CITY OF LANCASTER, GRANT COUNTY, WISCONSIN, THE BOUNDARIES OF SAID PARCEL BEING AGREED UPON LINES WITH ADJOINERS AND AS DESIGNATED TO ME BY JAMES SHERWIN OF LANCASTER, WISCONSIN.

NEW DESCRIPTION TO BE USED:

COMMENCING AT A FOUND 1" IRON PIPE MARKING THE NW CORNER OF BLOCK 3, ASSESSMENT PLAT, CITY OF LANCASTER, GRANT COUNTY, WISCONSIN, SAID IRON PIPE BEING THE POINT OF BEGINNING;

THENCE S 88°25'54" E 67.55' ALONG THE SOUTH LINE OF LINDEN STREET;

THENCE S 00°30'12" W 53.58';

THENCE N 89°07'30" W 67.74' TO THE EAST LINE OF HARRISON STREET;

THENCE N 00°43'02" E 54.40' ALONG THE EAST LINE OF HARRISON STREET TO THE POINT OF BEGINNING, CONTAINING 3652 S.F., MORE OR LESS, AND BEING SUBJECT TO ANY AND ALL EASEMENTS OF RECORD.

SURVEYOR'S CERTIFICATE: I, LARRY L. AUSTIN, REGISTERED WISCONSIN LAND SURVEYOR, DO HEREBY CERTIFY THAT I HAVE PREPARED THE ABOVE DESCRIPTION UNDER THE DIRECTION OF JACK KUSSMAUL, ATTORNEY, OF LANCASTER, AND TO THE BEST OF MY KNOWLEDGE AND BELIEF, THIS DESCRIPTION IS AN ACCURATE REPRESENTATION THEREOF.

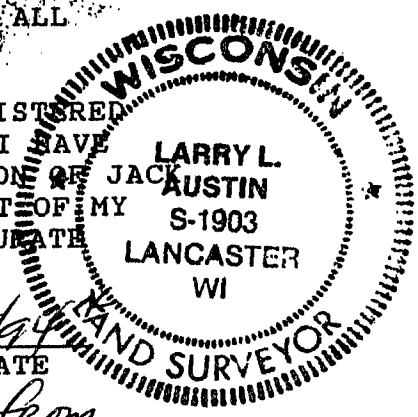

Larry L. Austin
LARRY L. AUSTIN RLS 1903
LARRY AUSTIN ENGINEERING
RT. 2
LANCASTER, WI. 53813
PHONE (608) 723-6363

7/25/94
DATE

Revised from
1-26-93
orig DATE: 11-1-92

BEARING REFERENCE: FOR PURPOSES OF THIS SURVEY BEARINGS ARE REFERENCED TO THE EAST LINE OF HARRISON STREET WHICH IS ASSUMED TO BEAR N 00°43'02" E.

