

PLAT AND DESCRIPTION

\*29

SHT 1/2

VENTURELLI/ PW5  
CENT. 21

OF 3.62 ACRES +/- PARCEL OF LAND OWNED BY FRANK VENTURELLI BEING LOCATED IN SE 1/4 OF THE NE 1/4 OF SECTION 25, T 1 N, R 1 W OF THE 4TH P.M., VILLAGE OF HAZEL GREEN, GRANT COUNTY, WISCONSIN, SAID PARCEL BEING DESCRIBED AS FOLLOWS:

COMMENCING AT THE E 1/4 CORNER OF SECTION 25, T 1 N, R 1 W OF THE 4TH P.M., GRANT COUNTY, WISCONSIN; THENCE NORTH 45.00'; THENCE S 89° 16' 46" W 595.39' TO THE POINT OF BEGINNING;

- THENCE S 89° 16' 46" W 241.56';
- THENCE N 00° 43' 16" W 100.00';
- THENCE S 89° 16' 46" W 100.00';
- THENCE N 00° 43' 16" W 10.00';
- THENCE S 89° 16' 46" W 112.94';
- THENCE S 07° 25' 45" E 110.76';
- THENCE S 89° 16' 46" W 48.41';
- THENCE N 07° 25' 45" W 180.27';
- THENCE N 18° 51' 22" W 78.17';
- THENCE N 15° 02' 02" W 58.55';
- THENCE S 89° 57' 47" E 31.59';
- THENCE N 00° 02' 13" E 50.00';
- THENCE EAST 128.00';
- THENCE S 86° 39' E 395.02';

THENCE SOUTH 329.90' TO THE POINT OF BEGINNING, CONTAINING 3.62 ACRES, MORE OR LESS, AND BEING SUBJECT TO ANY AND ALL EASEMENTS OF RECORD.

SURVEYOR'S CERTIFICATE: I, LARRY L. AUSTIN, REGISTERED WISCONSIN LAND SURVEYOR, HEREBY CERTIFY THAT I HAVE PREPARED THE ABOVE DESCRIPTION AND PLAT UNDER THE DIRECTION AND INSTRUCTIONS OF PAT MALONE OF CENTURY 21, AND TO THE BEST OF MY KNOWLEDGE AND BELIEF, THIS PLAT AND DESCRIPTION ARE A REPRESENTATION THEREOF.

*Larry L. Austin*  
 \_\_\_\_\_  
 LARRY L. AUSTIN RLS. 1903  
 LARRY AUSTIN ENGINEERING  
 RT. 2  
 LANCASTER, WI. 53813  
 PHONE (608) 723-6363

*3/24/94*  
 DATE  
*Revised from*  
*2/23/94 JH*

\* SEE NOTE ON SHEET 2

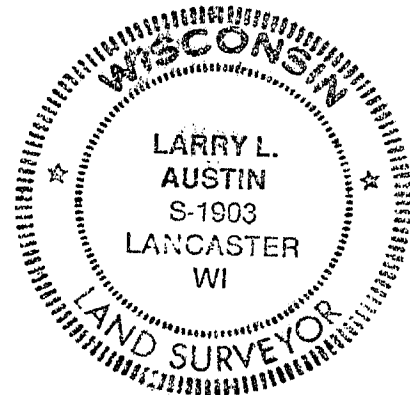

E 1/4 COR., SEC. 25, T1N, R1W  
OF THE 4TH P.M., GRANT CO. WI

# PLAT AND DESCRIPTION\*

\* NOTE: THIS PLAT AND DESCRIPTION PREPARATION BASED ON A 1988 BOUNDARY SURVEY BY "SCHMIT ENGR. & SURVEYING" AND OTHER SURVEYS WITHIN THIS SURVEY. NO INVESTIGATIONS MADE REGARDING MONUMENTATION OF SOME CORNERS OF THIS PARCEL.

NORTH 45.00'

SOUTH - 329.90'

### LEGEND

- ▲ 7/8" SOLID BAR
- △ 3/4" SOLID BAR
- 1" IRON PIPE

P.O.B. OF DESCRIPTION

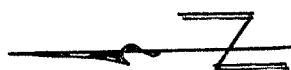

SCALE: 1"=60'

3.62 AC. ±

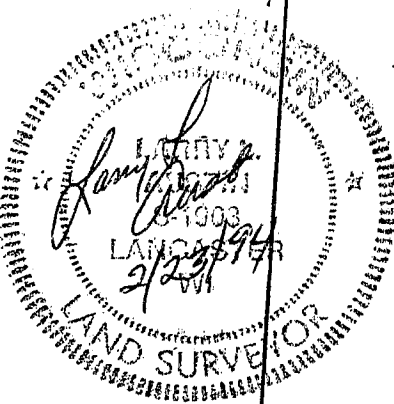

S 86° 39' E - 395.02'

EAST - 128.00'  
S N 00° 02' 13" E - 50.00'

N 00° 43' 16" W - 100.00'

S 89° 16' 46" W - 100.00'

N 00° 43' 16" W - 10.00'

S 89° 16' 46" W - 112.94'

1993 SURVEY BY AUSTIN

S 07° 25' 45" E - 110.76'

S 89° 16' 46" W - 48.41'

(14TH ST.)

N 07° 25' 45" W - 180.27'

N 18° 51' 22" W - 78.17'

N 15° 02' 02" W - 58.55'

1992 SURVEY

1993 SURVEY

1989 SURVEY (STUDTMAN)

S 89° 57' 47" E - 31.59'