

SURVEY PLAT

SHT 1 OF 1
GARY BAKER

REC'D JUL 5 1994

25

OF A 5 ACRE PARCEL OF LAND LOCATED IN THE NW 1/4 OF SECTION 35, T 4 N, R 2 W OF THE 4TH P.M., GRANT COUNTY, WISCONSIN, AND BEING MORE PARTICULARLY DESCRIBED AS FOLLOWS:

COMMENCING AT THE W 1/4 CORNER OF SECTION 35, T 4 N, R 2 W OF THE 4TH P.M., GRANT COUNTY, WISCONSIN; THENCE S 89°09'21" E 2284.11' ALONG THE E-W 1/4 LINE; THENCE N 00°50'34" E 464.36' TO A POINT IN THE CENTER LINE OF BAKER-JENTZ ROAD, SAID POINT BEING THE POINT OF BEGINNING;

THENCE N 04°29'41" W 460.40';

THENCE S 85°30'19" W 418.00';

THENCE S 04°29'40" E 589.09' TO A POINT IN THE CENTER LINE OF SAID BAKER-JENTZ ROAD;

THENCE N 66°42'34" E 203.04' ALONG THE CENTER LINE OF SAID ROAD;

THENCE N 68°32'52" E 71.39' ALONG THE CENTER LINE OF SAID ROAD;

THENCE N 70°25'21" E 163.13' ALONG THE CENTER LINE OF SAID ROAD TO THE POINT OF BEGINNING, CONTAINING 5.00 ACRES, MORE OR LESS, AND BEING SUBJECT TO ANY AND ALL EASEMENTS RECORD, INCLUDING NOT LIMITED TO A 33' WIDE R.O.W. EASEMENT FOR BAKER-JENTZ ROAD, SAID EASEMENT BEING LOCATED NORTHERLY OF AND ADJACENT TO THE SOUTHERLY LINE OF THE ABOVE DESCRIBED PARCEL.

SURVEYOR'S CERTIFICATE: I, LARRY L. AUSTIN, REGISTERED WISCONSIN LAND SURVEYOR, DO HEREBY CERTIFY THAT I HAVE SURVEYED, MAPPED AND MONUMENTED THAT PROPERTY SHOWN HEREON IN ACCORDANCE WITH THE INSTRUCTIONS OF PAT MALONE OF CENTURY 21, PLATTEVILLE, AND TO THE BEST OF MY KNOWLEDGE AND BELIEF, THIS PLAT IS AN ACCURATE REPRESENTATION THEREOF.

Larry L. Austin
LARRY L. AUSTIN RLS 1903
LARRY AUSTIN ENGINEERING
RT. 2
LANCASTER, WI. 53813
PHONE (608) 723-6363

4/7/94
DATE
Revised 4/12/94 *GB*

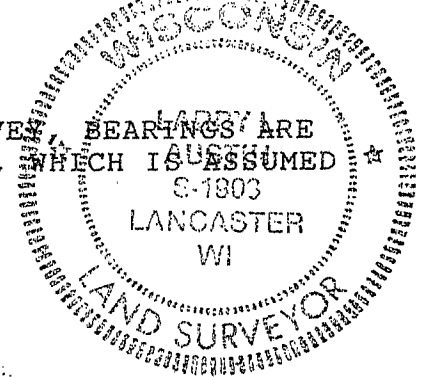

BEARING REFERENCE: FOR PURPOSES OF THIS SURVEY, BEARINGS ARE REFERENCED TO THE E-W 1/4 LINE OF SECTION 35, WHICH IS ASSUMED TO BEAR S 89°09'21" E.

LEGEND

- 1" X 24" IRON PIPE SET
- ▲ 3/4" IRON BAR FND.
- 1 1/4" IRON PIPE
- FD. IRON PIPE

