

# MORTGAGE INSPECTION

BEV JOHANSON

24

FOR: ROUNTREE REALTY  
PLATTEVILLE, WI

### STATEMENTS REGARDING WORK TO BE DONE:

AS CLIENT(S) OF LARRY L. AUSTIN, WISCONSIN LAND SURVEYOR, I/WE HEREBY REQUEST THAT THE SURVEY BE MADE ACCORDING TO THE FOLLOWING SPECIFICATIONS:

- 1) ONLY ENOUGH WORK BE PERFORMED TO SATISFY THE REQUIREMENTS OF: ROUNTREE REALTY OF PLATTEVILLE, WI.
- 2) NO STAKES BE SET TO MARK THE CORNERS OF THE PARCEL.
- 3) THE EXACT LENGTH AND BEARINGS OF THE BOUNDARIES OF THE PARCEL NEED NOT BE SHOWN.
- 4) MEASUREMENTS NEED NOT BE TAKEN AS SPECIFIED IN A-E 7.06 OF THE WISCONSIN ADMINISTRATIVE CODE. IT IS SPECIFICALLY INTENDED TO EXEMPT THIS SURVEY FROM THE REQUIREMENTS OF A-E 7.05 (3), 7.06 AND A-E 7.07 OF THE WISCONSIN ADMINISTRATIVE CODE.

DATE \_\_\_\_\_

SURVEYOR'S CERTIFICATE: I HEREBY CERTIFY THAT I HAVE SURVEYED THE ABOVE PARCEL AND THAT THE MAP SHOWN HEREON IS A TRUE AND CORRECT REPRESENTATION THEREOF TO THE BEST OF MY KNOWLEDGE AND BELIEF, AND SHOWS THE SIZE AND LOCATION OF THE PARCEL, IT'S RECORDED EXTERIOR BOUNDARIES, THE LOCATION OF VISIBLE ROADWAYS AND ENCROACHMENTS, IF ANY. THIS SURVEY IS MADE FOR THE USE OF THE PRESENT OWNERS OF THE PROPERTY AND THOSE WHO PURCHASE, MORTGAGE OR GUARANTEE TITLE THERETO WITHIN 6 MONTHS FROM THE DATE HEREON.

*Larry L. Austin*  
 LARRY L. AUSTIN, RLS 1903  
 LARRY AUSTIN ENGINEERING  
 RT. 2  
 LANCASTER, WISCONSIN 53813  
 PHONE (608) 723-6363

DATE 7/7/94  
 AUSTIN  
 S-1903  
 LANCASTER  
 WI

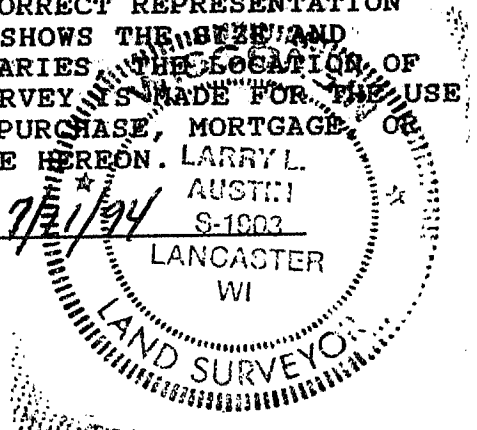

DESCRIPTION PROVIDED: LOT TWO (2) OF BLOCK TWO (2) IN PRESTON HEIGHTS SUBDIVISION IN THE CITY OF PLATTEVILLE, GRANT COUNTY, WISCONSIN, ACCORDING TO THE RECORDED MAP OR PLAT THEREOF.

