

SURVEY PLAT

REC'D JUL 5 1994

DEL SCHUSTER

OF THAT PROPERTY DESCRIBED IN VOLUME 518 AT PAGE 321, GRANT COUNTY REGISTRY, LANCASTER, WI., AND BEING DESCRIBED AS FOLLOWS:

23

"ALL THAT CERTAIN PARCEL OF LAND SITUATED ON THE E.1/2 OF THE N.E.1/4 OF SECTION 3, T 4 N, R 3 W, IN THE CITY OF LANCASTER, GRANT CO., WIS., DESCRIBED AS FOLLOWS: COMMENCING AT THE SOUTH EAST CORNER ON ADAMS STREET IN SAID CITY OF THAT LAND CONVEYED BY REBECCA CROFT BY DEED RECORDED IN THE OFFICE OF THE REGISTER OF DEEDS OF SAID COUNTY, IN "112-467" AND AT THE NORTH EAST CORNER OF LAND FORMERLY OWNED BY J.W. ALCORN AND BEFORE HIM BY J. MAHAN, AND RUNNING NORTH ALONG THE WEST LINE OF SAID ADAMS STREET 120 FEET, THENCE WEST 240 FEET, THENCE SOUTH 120 FEET, TO THE SOUTH EAST CORNER OF LAND FORMERLY OWNED BY WILLIAM BARTO, THENCE EAST 240 FEET TO THE PLACE OF BEGINNING; WHICH IS ALSO DESCRIBED AS LOT 15 BLOCK 108 OF THE ASSESSMENT PLAT OF SAID CITY."

SURVEYOR'S CERTIFICATE: I, LARRY L. AUSTIN, REGISTERED WISCONSIN LAND SURVEYOR, DO HEREBY CERTIFY THAT THIS PLAT AND SURVEY WERE PREPARED BY ME OR UNDER MY DIRECT SUPERVISION FROM INFORMATION FURNISHED TO ME BY DELBERT SCHUSTER, AND TO THE BEST OF MY KNOWLEDGE AND BELIEF, THIS PLAT IS AN ACCURATE REPRESENTATION OF SAID SURVEY.

Larry L. Austin
LARRY L. AUSTIN
LARRY AUSTIN ENGINEERING
RT. 2
LANCASTER, WI. 53813
PHONE (608)723-6363

RLS 1903

4/16/94
DATE

BEARING REFERENCE: FOR PURPOSES OF THIS SURVEY BEARINGS ARE REFERENCED TO THE WEST LINE OF ADAMS STREET WHICH IS ASSUMED TO BEAR N 00°16'57" W

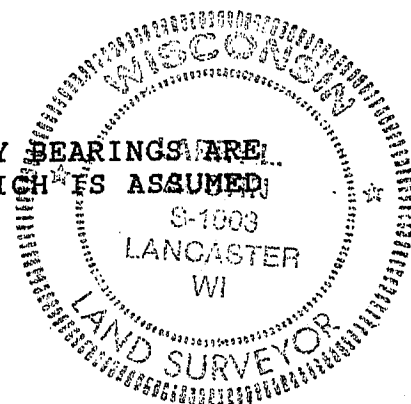

NOTE: ASS'MT PLAT LOTS SHOWN FOR GENERAL REFERENCE ONLY.

