

REC'D JUL 5 1994

SURVEY PLAT

OF A PARCEL OF LAND LOCATED IN N 1/2 OF SECTION 20, T 4 N, R 4 W, OF THE 4TH P.M., GRANT COUNTY, WISCONSIN AND BEING MORE PARTICULARLY DESCRIBED AS FOLLOWS:

COMMENCING AT THE NE CORNER OF SECTION 20, T 4 N, R 4 W, OF THE 4TH P.M., GRANT COUNTY, WISCONSIN; THENCE N 88° 33' 49" W 274.15' ALONG THE NORTH LINE OF SAID SECTION 20 TO THE POINT OF BEGINNING;

- THENCE N 88° 33' 49" W 324.46';
- THENCE S 03° 19' 36" E 882.55';
- THENCE N 83° 15' 37" W 745.55';
- THENCE N 02° 59' 10" E 173.09';
- THENCE S 88° 16' 43" W 1561.52';
- THENCE N 49° 31' 49" W 200.34';
- THENCE S 80° 25' 01" W 395.12';
- THENCE S 04° 14' 53" E 116.62';
- THENCE S 20° 45' 30" W 197.88';
- THENCE S 00° 29' 42" W 342.37'

TO A POINT IN THE CENTER LINE OF SHORT CUT ROAD;

- THENCE S 88° 54' 15" E 884.61' ALONG SAID CENTER LINE;
- THENCE S 88° 23' 22" E 1062.34' ALONG SAID CENTER LINE;
- THENCE S 86° 11' 43" E 172.86' ALONG SAID CENTER LINE;

THENCE SE'LY 1147.76' ALONG SAID CENTER LINE ON THE ARC OF A CURVE CONCAVE S'LY HAVING A RADIUS OF 3531.11' AND A LONG CHORD WHICH BEARS S 76° 53' 00" E 1142.72';

- THENCE N 10° 07' 49" E 227.03';
- THENCE S 87° 45' 31" E 220.31' TO THE EAST LINE OF SECTION 20;
- THENCE N 01° 58' 48" W 300.01' ALONG SAID LINE;
- THENCE N 84° 06' 27" W 266.86';
- THENCE N 02° 29' 38" W 1015.35'

TO THE POINT OF BEGINNING, CONTAINING 53.531 ACRES, MORE OR LESS, AND BEING SUBJECT TO ANY AND ALL EASEMENTS OF RECORD, INCLUDING, BUT NOT LIMITED TO A 33' WIDE R.O.W. EASEMENT FOR SHORT CUT ROAD, SAID EASEMENT BEING LOCATED ADJACENT TO AND NORTHERLY OF THE SOUTHERLY LINE OF THE ABOVE DESCRIBED PARCEL, AND ALSO BEING SUBJECT TO A 33' WIDE R.O.W. EASEMENT FOR CENTER LANE, SAID EASEMENT BEING LOCATED ADJACENT TO AND WESTERLY OF THE EASTERNMOST LINE OF THE ABOVE DESCRIBED PARCEL.

SURVEYOR'S CERTIFICATE: I, LARRY L. AUSTIN, REGISTERED WISCONSIN LAND SURVEYOR, DO HEREBY CERTIFY THAT THE ABOVE SURVEY, DESCRIPTION AND PLAT WERE PREPARED BY ME OR UNDER MY DIRECT SUPERVISION, ALL IN ACCORDANCE WITH THE INSTRUCTIONS OF BURNELL MAYNE, AND TO THE BEST OF MY KNOWLEDGE AND BELIEF, THIS PLAT IS AN ACCURATE REPRESENTATION THEREOF.

*Larry L. Austin*

LARRY L. AUSTIN  
LARRY AUSTIN ENGINEERING  
4211 HWY 81 E  
LANCASTER, WI 53813  
PHONE (608) 723-6363

RLS 1903

2/5/94  
DATE

BEARING REFERENCE: FOR PURPOSES OF THIS SURVEY BEARINGS ARE REFERENCED TO THE NORTH LINE OF THE NE 1/4 OF SECTION 20, WHICH IS ASSUMED TO BEAR N 88 33' 49" W.

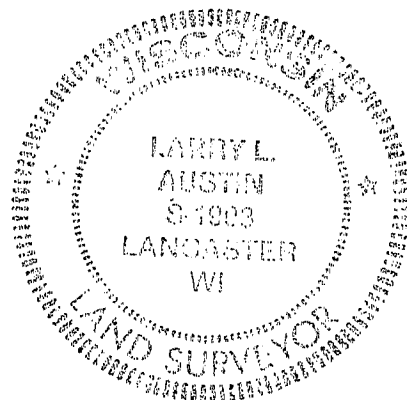

# SURVEY PLAT

SHT. 2 OF 2  
- BURNELL MAYNE

SCALE: 1" = 400'

