



567357

Page 2 of 4

JUN 3 1994 CERTIFIED SURVEY MAP #373

FOR

NORBERT PINK

I, Sean M. Walsh, Registered Land Surveyor, do hereby certify that I have surveyed, divided and mapped all that part of the Southeast One-quarter of the Northeast One-quarter and part of the Northeast One-quarter of the Southeast One-quarter of Section 33, Township 5 North, Range 3 West, Town of North Lancaster, Grant County, Wisconsin, bounded and described as follows:

Commencing at the East One-quarter corner of Section 33; thence West, along the South line of the Northeast One-quarter, 503.21 feet to the place of beginning of the parcel hereinafter described; thence South 00°28' 23" East, 3.87 feet to a point on the centerline of Pine Knob Road; thence South 89°24' 36" West, along said centerline, 317.82 feet; thence North 01° 44' 12" West, 309.27 feet; thence North 88° 47' 43" East, 98.09 feet; thence South 00°20' 39" West, 145.12 feet; thence South 85°50' 02" East, 229.38 feet; thence South 00° 28' 23" East, 148.14 feet to the place of beginning, containing 64,418 square feet or 1.479 acres of land.

Reserving therefrom a 20 foot wide easement for ingress and egress the centerline of which is described as follows: Commencing at the East One-quarter corner of Section 33; thence West, along the South line of Northeast One-quarter of section 33, 687.52 feet to the place of beginning of the centerline hereinafter described; thence North 00° 11' 31" West, 155.65 feet to the point of termination of said centerline.

Reserving therefrom a strip of land 33 feet in width lying North of and adjacent to the above described centerline of Pine Knob Road for Town Road Purposes.

That I have made this survey, map and land division at the direction of Mr. Norbert Pink, owner of said land.

That Such map is a correct representation of all the exterior boundaries of the land surveyed and the division thereof made.

That I have fully complied with the provisions of Chapter 236 of the Wisconsin Statutes and the ordinances of Grant County in surveying, dividing and mapping the same.

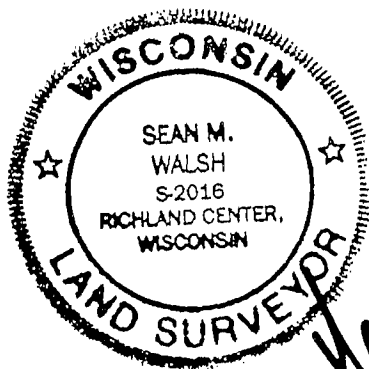

Sean M. Walsh
11-18-94

GRANT COUNTY, WI
RECEIVED FOR RECORD

MAY 17 1994

at 4:23 P.M. and recorded in
Vol. 2 of Records Page 263
Monahan Register