

Sec 3, T4N, R3W

BENCHMARK SURVEYS  
OF SOUTHWESTERN WISCONSIN, INC.

PLAT OF SURVEY  
FOR

86

P.O. BOX 486 (608) 647-8533  
RICHLAND CENTER, WISCONSIN 53581

JOHN F. BIBA

REC'D MAR 8 1994

SCALE: 1" = 60'

Part of Block 9 of Burt's Addition to the City of Lancaster, being located in part of the Northeast One-quarter of Section 3, Township 4 North, Range 3 West, City of Lancaster, Grant County, Wisconsin.



● - 3/4" IRON ROD PLACED

● 1" SOLID IRON ROD FOUND

BIRCH STREET

R/W 60'

N 88°53' 39" E 193.92'

3/4" IRON ROD PLACED

3/4" IRON ROD PLACED

BLOCK 9

60.00'

100.00'

GARAGE ON ADJOINING PROPERTY ENCLOSED

97.00'

CHISELED X

PARCEL "B"

N 88°53' 47" E / 92.63'

ASPHALT DRIVE

3.00'

DWELLING

80.00'

PARCEL "A"

100.00'

N 01°45' 03" W 300.00'

72.00'

R/W 60' S 01°08' 02" E 300.00'

S 88°53' 53" W 91.77'

BURTS ADDITION

100.00'

100.00'

3/4" IRON ROD PLACED

1" SOLID IRON ROD FOUND

S 88°53' 59" W 190.70'

R/W 60'

LINDEN STREET

● 1" IRON PIPE FOUND

"I HAVE SURVEYED THE ABOVE DESCRIBED PROPERTY, AND THE ABOVE MAP IS A TRUE REPRESENTATION THEREOF AND SHOWS THE SIZE AND LOCATION OF THE PROPERTY, ITS EXTERIOR BOUNDARIES, THE LOCATION AND DIMENSIONS OF ALL STRUCTURES THEREON, FENCES, ROADWAYS, APPARENT EASEMENTS AND ENCROACHMENTS, IF ANY.

"THIS SURVEY IS MADE FOR THE EXCLUSIVE USE OF THE PRESENT OWNERS OF THE PROPERTY, AND ALSO THOSE WHO PURCHASE, MORTGAGE OR GUARANTEE THE TITLE THEREOF, WITHIN ONE (1) YEAR FROM DATE HEREOF; AND AS TO THEM I HEREBY CERTIFY THAT SAID SURVEY AND THE ABOVE MAP WERE MADE IN ACCORDANCE WITH ACCEPTABLE PROFESSIONAL STANDARDS AND THAT THE INFORMATION CONTAINED HEREON IS, TO THE BEST OF MY KNOWLEDGE, INFORMATION AND BELIEF A TRUE AND ACCURATE REPRESENTATION THEREOF."

DATED July 19 19 93 Sean M. Walsh

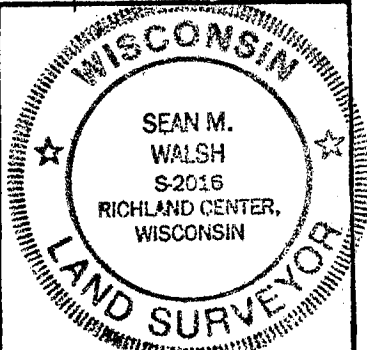

**BENCHMARK SURVEYS  
OF  
SOUTHWESTERN WISCONSIN, INC.**  
P. O. Box 486  
Richland Center, WI 53581

**DESCRIPTION FOR JOHN F. BIBA**

**PARCEL "A"**

All that part of Block 9 of Burt's Addition to the City of Lancaster, bounded and described as follows:  
Commencing at the Southeast corner of Block 9; thence South 88° 53' 59" West, along the South line of Block 9, 190.70 feet to a point on the Easterly right-of-way line of U. S. H. "61"; thence North 01° 45' 03" West, along said Easterly Right-of-way, 100.00 feet to the place of beginning of the parcel hereinafter described; thence continuing North 01° 45' 03" West, along said right-of-way, 77.00 feet; thence North 88° 53' 47" East, 92.63 feet; thence South 01° 08' 02" East, 77.00 feet; thence South 88° 53' 53" West, 91.77 feet to the place of beginning.

**PARCEL "B"**

All that part of Block 9 of Burt's Addition to the City of Lancaster, bounded and described as follows:  
Commencing at the Southeast corner of Block 9, thence South 88° 53' 59" West, along the South line of Block 9, 190.70 feet to a point on the Easterly right-of-way line of U. S. H. "61"; thence North 01° 45' 03" West, along said Easterly right-of-way line, 177.00 feet to the place of beginning of the parcel hereinafter described; thence continuing North 01° 45' 03" West, along said right-of-way line, 3.00 feet; thence North 88° 53' 47" East, 92.63 feet; thence South 01° 08' 02" East, 3.00 feet; thence South 88° 53' 47" West, 92.63 feet to the place of beginning.

The above described parcels of land being located in part of the Northeast One-quarter of Section 3, Township 4 North, Range 3 West, City of Lancaster, Grant County, Wisconsin.

