

SURVEY PLAT

-JIM LANGMEIER-

OF A PARCEL OF LAND LOCATED IN THE N 1/2 OF THE SE 1/4 OF SECTION 27, T 6 N , R 5 W OF THE 4TH P.M., GRANT COUNTY, WISCONSIN, AND BEING MORE PARTICULARLY DESCRIBED AS FOLLOWS:

COMMENCING AT THE E 1/4 CORNER OF SECTION 27, T 6 N , R 5 W OF THE 4TH P.M., GRANT COUNTY, WISCONSIN; THENCE S 01° 03'33" W 682.11' ALONG THE EAST LINE OF SAID SECTION 27; THENCE N 88° 56'27" W 1281.14' TO A POINT IN THE CENTERLINE OF MILITARY RIDGE ROAD AND HICKLIN HOLLOW ROAD, SAID POINT BEING THE POINT OF BEGINNING;

THENCE S 49° 02'23" W 408.54' ALONG THE CENTERLINE OF HICKLIN HOLLOW ROAD;

- THENCE N 40° 57'37" W 72.49';
- THENCE N 03° 16'07" E 39.84';
- THENCE N 13° 58'26" E 80.89';
- THENCE N 03° 11'18" E 71.95';
- THENCE N 27° 31'01" E 70.46';
- THENCE N 42° 10'17" E 120.03';
- THENCE N 72° 10'17" E 69.79'; TO A POINT IN THE

CENTERLINE OF MILITARY RIDGE ROAD; THENCE S 45° 09'21" E 212.49' ALONG SAID ROAD TO THE POINT OF BEGINNING; CONTAINING 1.768 ACRES, MORE OR LESS, AND BEING SUBJECT TO ANY AND ALL EASEMENTS OF RECORD, INCLUDING BUT NOT LIMITED TO 33' WIDE R/W EASEMENTS FOR HICKLIN HOLLOW ROAD AND MILITARY RIDGE ROAD AS SHOWN ON THIS PLAT.

SURVEYOR'S CERTIFICATE: I, LARRY L. AUSTIN, REGISTERED WISCONSIN LAND SURVEYOR, DO HEREBY CERTIFY THAT I HAVE SURVEYED, MAPPED, AND MONUMENTED THAT PROPERTY SHOWN HEREON IN ACCORDANCE WITH THE INSTRUCTIONS OF JIM LANGMEIER, AND IN THE BEST OF MY KNOWLEDGE AND BELIEF, THIS PLAT IS AN ACCURATE REPRESENTATION THEREOF.

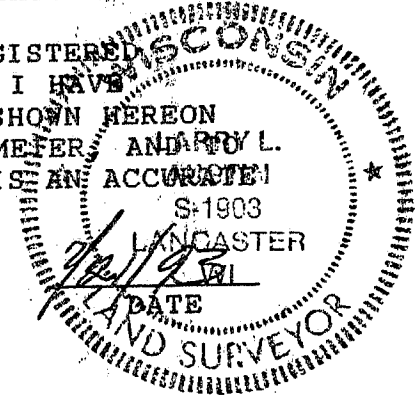

Larry L. Austin
LARRY L. AUSTIN RLS 1903
LARRY AUSTIN ENGINEERING
RT. 2
LANCASTER, WI. 53813
PHONE (608) 723-6363

LEGEND

- 1" x 24" IRON PIPE SET
- ▲ 3/4" IRON BAR FOUND
- WI D.O.T. ALUM. MON. FOUND
- △ 7/8" IRON BAR FOUND

