

# PLAT OF SURVEY

REC'D JAN 24 1994

SHT. 1 OF 1

DUNCAN/HALFERTY

66

Sec 30, T4N, R4W

OF THE EXTERIOR BOUNDARIES OF LOT 7, AND THE EASTERLY LINES OF LOT 8 AND LOT 9, IN THE VILLAGE OF BEETOWN, ACCORDING TO THE RECORDED PLAT THEREOF, BEING IN THE NE 1/4 OF SECTION 30, T 4 N, R 4 W OF THE 4TH P.M., GRANT COUNTY, WISCONSIN.

SURVEYOR'S CERTIFICATE: I, LARRY L. AUSTIN, REGISTERED WISCONSIN LAND SURVEYOR, DO HEREBY CERTIFY THAT I HAVE SURVEYED, MAPPED, AND MONUMENTED THAT PROPERTY SHOWN HEREON IN ACCORDANCE WITH THE INSTRUCTIONS OF JAMES B. HALFERTY, AND TO THE BEST OF MY KNOWLEDGE AND BELIEF, THIS PLAT IS AN ACCURATE REPRESENTATION THEREOF.

*Larry L. Austin*  
LARRY L. AUSTIN RLS 1903  
LARRY AUSTIN ENGINEERING  
RT. 2  
LANCASTER, WI. 53818  
PHONE (608) 723-6363

12/17/93  
DATE

REVISED 1/9/94

BEARING REFERENCE: FOR PURPOSES OF THIS SURVEY BEARINGS ARE REFERENCED TO THE NORTH LINE OF NE 1/4 OF SECTION 30, ASSUMED BEARING = N 89° 05' 51" W.

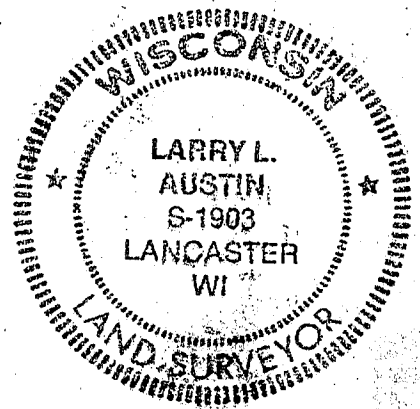

## LEGEND

- 0" 1" x 24" IRON PIPE SET
- ( ) RECORDED DIMEN. OR BRG.
- EXIST. FENCE
- FOUND STONE

