

60

MORTGAGE INSPECTION

OTT - DOLAN

FOR: ANCHOR SAVINGS AND LOAN
LANCASTER, WI

STATEMENTS REGARDING WORK TO BE DONE:

AS CLIENT(S) OF LARRY L. AUSTIN, WISCONSIN LAND SURVEYOR, I/WE HEREBY REQUEST THAT THE SURVEY BE MADE ACCORDING TO THE FOLLOWING SPECIFICATIONS:

- 1) ONLY ENOUGH WORK BE PERFORMED TO SATISFY THE REQUIREMENTS OF: ANCHOR SAVINGS AND LOAN OF LANCASTER, WI.
- 2) NO STAKES BE SET TO MARK THE CORNERS OF THE PARCEL.
- 3) THE EXACT LENGTH AND BEARINGS OF THE BOUNDARIES OF THE PARCEL NEED NOT BE SHOWN.
- 4) MEASUREMENTS NEED NOT BE TAKEN AS SPECIFIED IN A-E 7.06 OF THE WISCONSIN ADMINISTRATIVE CODE. IT IS SPECIFICALLY INTENDED TO EXEMPT THIS SURVEY FROM THE REQUIREMENTS OF A-E 7.05 (3), 7.06 AND A-E 7.07 OF THE WISCONSIN ADMINISTRATIVE CODE.

DATE _____

SURVEYOR'S CERTIFICATE: I HEREBY CERTIFY THAT I HAVE SURVEYED THE ABOVE PARCEL AND THAT THE MAP SHOWN HEREON IS A TRUE AND CORRECT REPRESENTATION THEREOF TO THE BEST OF MY KNOWLEDGE AND BELIEF, AND SHOWS THE SIZE AND LOCATION OF THE PARCEL, IT'S RECORDED EXTERIOR BOUNDARIES, THE LOCATION OF VISIBLE ROADWAYS AND ENCROACHMENTS, IF ANY. THIS SURVEY IS MADE FOR THE USE OF THE PRESENT OWNERS OF THE PROPERTY AND THOSE WHO PURCHASE, MORTGAGE, OR GUARANTEE TITLE THERETO WITHIN 6 MONTHS FROM THE DATE HEREON.

DATE 7/22/93

Larry L. Austin
LARRY L. AUSTIN, RLS 1903
LARRY AUSTIN ENGINEERING RT. 2
PHONE (608) 723-6363

LANCASTER, WISCONSIN 53813

DESCRIPTION PROVIDED:

SEE SHEET 2 OF 2

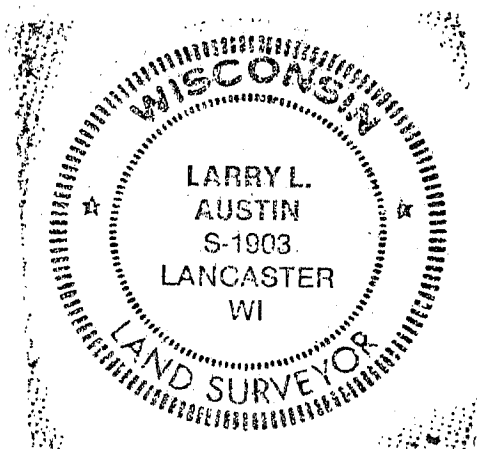

MORTGAGE INSPECTION

OTT - DOLAN

That part of the NW 1/4 of the SE 1/4 of Section 15, T 5 N, R 3 W of the 4th P.M., Grant County, Wisconsin, described as follows, to-wit: Commencing at the NE corner of the SE 1/4 of the NE 1/4 of said Section 15; thence S 00° 03' W 625.64 ft. along the East Section line of Sec. 15 to the centerline of the town road; thence S 39° 46' W, 1031.94 ft. along said centerline; thence S. 41° 35' W, 1072.91 ft. along said centerline to the point of beginning; thence S: 41° 35' W, 589.24 ft. along said centerline to the South line of the NW 1/4 of the SE 1/4 of Sec. 15; thence N. 89° 20' W, 910.46 ft. along said South line to the SW corner of the NW 1/4 of the SE 1/4 of Sec. 15; thence North, 720.00 ft. to the centerline of the creek; thence N 52° 15' E, 388.55 ft. along the centerline of the creek; thence S 62° 02' E, 1125.72 ft. to the centerline of the town road and the point of beginning.

