

# SURVEY PLAT

-DENNIS & MARK DIETZEL

AND CORRECTION DESCRIPTION TO BE USED FOR CORRECTION DEED FOR THAT PROPERTY OWNED BY DENNIS DIETZEL AND BEING LOCATED IN THE NW 1/4 OF THE SE 1/4 AND IN THE SW 1/4 OF THE SE 1/4 OF SECTION 27, T 2 N, R 2 W OF THE 4TH P.M., GRANT COUNTY, WISCONSIN, SAID PROPERTY BEING DESCRIBED AS FOLLOWS:

COMMENCING AT THE E 1/4 CORNER OF SECTION 27, T 2 N, R 2 W OF THE 4TH P.M., GRANT COUNTY, WISCONSIN; THENCE S 00° 24' 43" E 687.16' ALONG THE EAST LINE OF SAID SECTION 27; THENCE S 71° 25' 57" W 1697.66' TO A POINT ON THE WESTERLY R.O.W. OF U.S.H. # 61, SAID POINT BEING THE POINT OF BEGINNING;

THENCE SW'LY 266.68' ALONG THE WESTERLY R.O.W. OF SAID HIGHWAY ON THE ARC OF A CURVE CONCAVE NW'LY, SAID CURVE HAVING A RADIUS OF 3699.83' AND A LONG CHORD WHICH BEARS S 20° 49' 34" W 266.62';

THENCE S 22° 53' 28" W 68.38' ALONG SAID R.O.W.;

THENCE N 67° 06' 32" W 75.00' ALONG SAID R.O.W.;

THENCE S 22° 53' 28" W 212.87' ALONG SAID R.O.W.;

THENCE N 73° 48' 00" W 205.08';

THENCE N 01° 42' 13" W 266.75';

THENCE N 71° 25' 57" E 487.67' TO THE POINT OF BEGINNING,

CONTAINING 2.809 ACRES, MORE OR LESS, AND BEING SUBJECT TO ANY AND ALL EASEMENTS OF RECORD.

SURVEYOR'S CERTIFICATE: I, LARRY L. AUSTIN, REGISTERED WISCONSIN LAND SURVEYOR, DO HEREBY CERTIFY THAT I HAVE SURVEYED, MAPPED, AND MONUMENTED THAT PROPERTY SHOWN HEREON IN ACCORDANCE WITH THE INSTRUCTIONS OF DENNIS AND MARK DIETZEL AND TO THE BEST OF MY KNOWLEDGE AND BELIEF, THIS PLAT IS AN ACCURATE REPRESENTATION THEREOF.

*Larry L. Austin*  
LARRY L. AUSTIN RLS 1903  
4211 HWY 81 E  
LANCASTER, WI 53813  
PHONE (608) 723-6362

10/3/93  
DATE

BEARING REFERENCE: FOR PURPOSES OF THIS SURVEY BEARINGS ARE REFERENCED TO THE EAST LINE OF THE SE 1/4 CORNER SECTION 27, WHICH IS ASSUMED TO BEAR S 00° 24' 43" E.

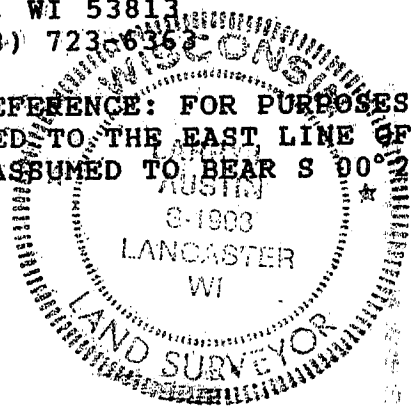

E 1/4 COR., SEC. 27,  
T2N, R2W OF 4TH P.M.,  
GRANT CO., WI.

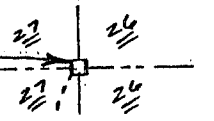

## LEGEND

- FND. DOT ALUM. MON.
- FND. 2" IRON PIPE
- FND. 1 1/4" IRON PIPE
- 1" IRON PIPE SET X 24" LONG
- ( ) REC. DIM. OR BRG

