

Sec 1, T2N, R2W

MORTGAGE INSPECTION SURVEY

FOR: M AND I MORT. CORP.

STATEMENTS REGARDING WORK TO BE DONE:
AS CLIENT(S) OF LARRY L. AUSTIN, WISCONSIN LAND SURVEYOR, I/WE HEREBY REQUEST THAT THE SURVEY BE MADE ACCORDING TO THE FOLLOWING SPECIFICATIONS:

- 1) ONLY ENOUGH WORK BE PERFORMED TO SATISFY THE REQUIREMENTS OF: M AND I MORT. CORP., MILWAUKEE, WI.
- 2) NO STAKES BE SET TO MARK THE CORNERS OF THE PARCEL.
- 3) THE EXACT LENGTH AND BEARINGS OF THE BOUNDARIES OF THE PARCEL NEED NOT BE SHOWN.
- 4) MEASUREMENTS NEED NOT BE TAKEN AS SPECIFIED IN A-E 7.06 OF THE WISCONSIN ADMINISTRATIVE CODE. IT IS SPECIFICALLY INTENDED TO EXEMPT THIS SURVEY FROM THE REQUIREMENTS OF A-E 7.05 (3), 7.06 AND A-E 7.07 OF THE WISCONSIN ADMINISTRATIVE CODE.

DATE _____

SURVEYOR'S CERTIFICATE: I HEREBY CERTIFY THAT I HAVE SURVEYED THE ABOVE PARCEL AND THAT THE MAP SHOWN HEREON IS A TRUE AND CORRECT REPRESENTATION THEREOF TO THE BEST OF MY KNOWLEDGE AND BELIEF, AND SHOWS THE SIZE AND LOCATION OF THE PARCEL, IT'S RECORDED EXTERIOR BOUNDARIES, THE LOCATION OF VISIBLE ROADWAYS AND ENCROACHMENTS, IF ANY. THIS SURVEY IS MADE FOR THE USE OF THE PRESENT OWNERS OF THE PROPERTY AND THOSE WHO PURCHASE, MORTGAGE, OR GUARANTEE TITLE THERETO WITHIN ONE YEAR FROM THE DATE HEREON.

Larry L. Austin
LARRY L. AUSTIN, RLS 1903

DATE 11/17/93

LARRY AUSTIN ENGINEERING
RT. 2
LANCASTER, WISCONSIN 53813
PHONE (608) 723-6363

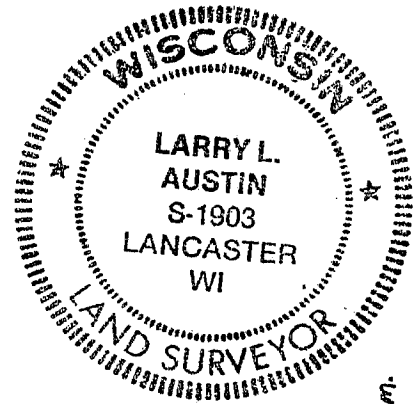

DESCRIPTION PROVIDED:
OF A PARCEL OF LAND LOCATED IN THE NE 1/4 OF THE SE 1/4 OF SECTION 1, T 2 N, R 2 W OF THE 4TH P.M., GRANT COUNTY, WISCONSIN, AND BEING MORE PARTICULARLY DESCRIBED AS FOLLOWS:

COMMENCING AT THE E 1/4 CORNER OF SECTION 1, T 2 N, R 2 W, OF THE 4TH P.M., GRANT COUNTY, WISCONSIN; THENCE S 01° 11' 39" W 133.80' ALONG THE EAST LINE OF SAID SECTION 1 TO THE POINT OF BEGINNING;
 THENCE S 01° 11' 39" W 596.20' ALONG THE EAST LINE OF SAID SECTION 1;
 THENCE S 88° 09' 30" W 1094.44' TO A POINT ON THE EASTERLY R.O.W. LINE OF U.S.H. 151;
 THENCE N 51° 11' 06" W 110.00' TO THE CENTER LINE OF SAID HWY.;
 THENCE N 38° 48' 54" E 742.06' ALONG SAID CENTER LINE;
 THENCE S 51° 11' 06" E 60.24' TO THE EASTERLY R.O.W. OF SAID U.S.H. 151;
 THENCE N 88° 09' 30" E 680.29' TO THE POINT OF BEGINNING,

CONTAINING 13.578 ACRES, MORE OR LESS, AND BEING SUBJECT TO ANY AND ALL EASEMENTS AND HIGHWAY CONVEYANCES OF RECORD.

E 1/4 COR, SEC 1,
T2N, R2W, 4TH P.M.
GRANT CO., WI

LEGEND

- ALUM. MON. FOUND
- FOUND IRON BARS
- () RECORDED DIM. OR BRG'S

