

- VANDERAH

Sec 33, T1N, R2W

42

OF A PARCEL OF LAND LOCATED IN SW 1/4 OF THE SE 1/4 OF SECTION 33, T 1 N, R 2 W OF THE 4TH P.M., GRANT COUNTY, WISCONSIN, AND BEING MORE PARTICULARLY DESCRIBED AS FOLLOWS:

COMMENCING AT THE SE CORNER OF SECTION 33, T 1 N, R 2 W OF THE 4TH P.M., GRANT COUNTY, WISCONSIN; THENCE N 89° 07' 09" W 1703.31' ALONG THE SOUTH LINE OF SAID SECTION 33 TO A POINT IN THE CENTER LINE OF S.T.H. 35, SAID POINT BEING THE POINT OF BEGINNING

THENCE N 89° 07' 09" W 59.88' ALONG THE SOUTH LINE OF SAID SECTION 33;

THENCE N 04° 23' 09" W 122.82';

THENCE S 73° 36' 44" E 105.25' TO A 3/4" IRON BAR;

THENCE S 33° 08' 27" E 65.08' TO THE CENTER LINE OF S.T.H. 35;

THENCE S 59° 47' 02" W 77.87' ALONG SAID CENTER LINE TO THE POINT OF BEGINNING, CONTAINING 0.262 ACRES, MORE OR LESS, AND BEING SUBJECT TO ANY AND ALL EASEMENTS OF RECORD, INCLUDING, BUT NOT LIMITED TO A 50' WIDE R.O.W. FOR S.T.H. 35 SAID R.O.W. BEING ADJACENT TO AND W'LY OF THE E'LY LINE OF THE ABOVE DESCRIBED PARCEL.

SURVEYOR'S CERTIFICATE: I, LARRY L. AUSTIN, REGISTERED WISCONSIN LAND SURVEYOR, DO HEREBY CERTIFY THAT I SURVEYED, MAPPED AND MONUMENTED THAT PROPERTY SHOWN HEREON IN ACCORDANCE WITH THE INSTRUCTIONS OF MEL VANDERAH, AND TO THE BEST OF MY KNOWLEDGE AND BELIEF, THIS PLAT IS AN ACCURATE REPRESENTATION THEREOF.

Larry L. Austin
LARRY L. AUSTIN RLS 1903
LARRY AUSTIN ENGINEERING
RT. 2
LANCASTER, WI. * 53813
PHONE (608) 723-6363

8/23/93
DATE

BEARING REFERENCE: FOR PURPOSES OF THIS SURVEY BEARINGS ARE REFERENCED TO THE SOUTH LINE OF THE SE 1/4 OF SECTION 33, WHICH IS ASSUMED TO BEAR N 89 07' 09" W.

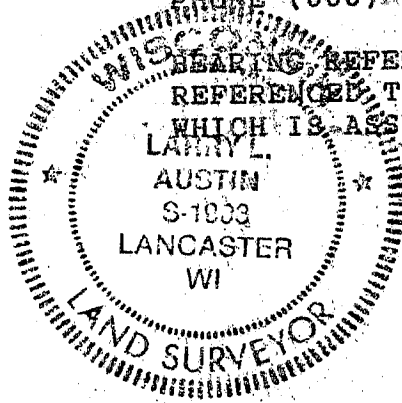

LEGEND

- EXISTING 3/4" IRON BAR
- EXISTING ALUM. MON.
- 3/4" x 24" SOLID ROUND BAR SET

