

Sec 3, T3N, R1W  
**SURVEY PLAT**

REC'D JAN 24 1994

36

-KLINGER

DD 2A FB

PW3

OF A PARCEL OF LAND LOCATED IN THE SE 1/4 OF THE NE 1/4 OF SECTION 3, T 3 N, R 1 W OF THE 4TH P.M., GRANT COUNTY, WISCONSIN, AND BEING MORE PARTICULARLY DESCRIBED AS FOLLOWS:

COMMENCING AT THE E 1/4 CORNER OF SECTION 3, T 3 N, R 1 W OF THE 4TH P.M., GRANT COUNTY, WISCONSIN; THENCE N 89°35'07" W 929.95' TO THE POINT OF BEGINNING;  
 THENCE N 89°35'07" W 400.00' TO THE SW CORNER OF THE E 1/2 OF THE NE 1/4 OF SAID SECTION 3;  
 THENCE N 00°34'49" E 544.50' ALONG THE WEST LINE OF SAID E 1/2 OF THE NE 1/4;  
 THENCE S 89°35'07" E 400.00';  
 THENCE S 00°34'49" W 544.50' TO THE POINT OF BEGINNING, CONTAINING 5.000 ACRES MORE LESS, AND BEING SUBJECT TO ANY AND ALL EASEMENTS OF RECORD, INCLUDING BUT NOT LIMITED TO AN EASEMENT FOR ROAD RIGHT OF WAY FOR WALNUT DELL ROAD, SAID EASEMENT BEING DESCRIBED AS FOLLOWS:

**EASEMENT FOR WALNUT DELL ROAD**

COMMENCING AT THE E 1/4 COR OF SECTION 3, T 3 N, R 1 W OF THE 4TH P.M., GRANT COUNTY, WISCONSIN; THENCE N 89°35'07" W 929.95' TO THE POINT OF BEGINNING; THENCE N 89°35'07" E 400.00'; THENCE N 00°34'49" E 17.00'; THENCE N 89°50'31" E 400.03'; THENCE S 00°34'49" W 21.00' TO THE POINT OF BEGINNING.

SURVEYOR'S CERTIFICATE: I, LARRY L. AUSTIN, REGISTERED WISCONSIN LAND SURVEYOR, DO HEREBY CERTIFY THAT I HAVE SURVEYED, MAPPED, AND MONUMENTED THAT PROPERTY SHOWN HEREON IN ACCORDANCE WITH THE INSTRUCTIONS OF CLAYTON REAL ESTATE AND AUCTION SERVICE INC., OF PLATTEVILLE, WISCONSIN, AND TO THE BEST OF MY KNOWLEDGE AND BELIEF THIS PLAT IS AN ACCURATE REPRESENTATION THEREOF.

*Larry L. Austin*  
 LARRY L. AUSTIN  
 4211 HWY 81 E  
 LANCASTER, WI 53813  
 PHONE (608) 723-6363

RLS 1903

11-5-93  
 DATE

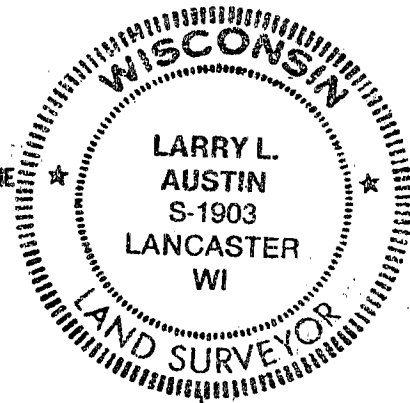

BEARING REFERENCE: FOR PURPOSES OF THIS SURVEY BEARINGS ARE REFERENCED TO THE E LINE OF THE NE 1/4 OF SECTION 3, WHICH IS ASSUMED TO BEAR S 00°32'14" W

