

GRANT COUNTY CLERK RECEIVED

JUN 16 1993

Sec 21, 28
T5N
R6W

95

PLAT OF SURVEY FOR MARJORIE GARTHWAITE

LOCATED IN PART OF THE SW 1/4 OF THE SE 1/4, PART OF THE NW 1/4 OF THE SE 1/4, PART OF THE NE 1/4 OF THE SW 1/4 AND PART OF THE SE 1/4 OF THE SW 1/4 ALL IN SECTION 21, AND PART OF THE NW 1/4 OF THE NE 1/4 OF SECTION 28 ALL IN TOWNSHIP 5 NORTH, RANGE 6 WEST, TOWNSHIP OF BLOOMINGTON, GRANT COUNTY, WISCONSIN.

DESCRIPTION OF PARCEL "A"

COMMENCING AT THE SOUTHEAST CORNER OF SECTION 21; THENCE SOUTH 89° 33' 00" WEST, ALONG THE SOUTH LINE OF THE SOUTHEAST ONE-QUARTER OF SECTION 21, 1696.03 FEET TO THE PLACE OF BEGINNING OF THE PARCEL HEREINAFTER DESCRIBED; THENCE CONTINUING SOUTH 89° 33' 00" WEST, ALONG SAID SOUTH LINE, 535.96 FEET TO A POINT ON A LINE MEANDERING THE NORMAL LOW WATER LINE OF THE EASTERLY SHORE OF THE MISSISSIPPI RIVER; THENCE NORTH 37° 51' 52" WEST ALONG SAID MEANDER LINE, 245.30 FEET THENCE NORTH 25° 24' 14" WEST, ALONG SAID MEANDER LINE, 359.28 FEET; THENCE NORTH 14° 31' 38" WEST, ALONG SAID MEANDER LINE, 227.16 FEET; THENCE NORTH 30° 59' 37" WEST, ALONG SAID MEANDER LINE, 378.98 FEET; THENCE NORTH 19° 52' 00" EAST, ALONG SAID MEANDER LINE, 340.69 FEET TO A POINT ON THE SOUTHWESTERLY RIGHT-OF-WAY LIMITS OF THE BURLINGTON NORTHERN RAILROAD; THENCE SOUTH 36° 09' 43" EAST, ALONG THE SOUTHWESTERLY RIGHT-OF-WAY LINE OF THE BURLINGTON NORTHERN RAILROAD, 123.31 FEET; THENCE NORTH 89° 57' 29" WEST, ALONG SAID RIGHT-OF-WAY, 18.64 FEET; THENCE SOUTH 36° 09' 43" EAST, ALONG SAID RIGHT-OF-WAY, 790.00 FEET; THENCE NORTH 89° 57' 29" WEST, ALONG SAID RIGHT-OF-WAY, 12.38 FEET; THENCE SOUTH 36° 09' 43" EAST, ALONG SAID RIGHT-OF-WAY 795.00 FEET TO THE PLACE OF BEGINNING CONTAINING 526.955 SQ. FT. OR 12.097 ACRES OF LAND.

SCALE 1" = 100'

- ▲ 3/4" X 24" IRON ROD PLACED BY THIS SURVEY
- BRASS CAPPED IRON PIPE LOCATED

PARCEL "A"
526,955 SQ. FT
12.097 ACRES

NOTE: THE RAILROAD RIGHT-OF-WAY HAS BEEN MARKED IN ACCORDANCE WITH THE MOST RECENT RIGHT-OF-WAY PLAT.

NOTE: THE DESCRIPTION OF PARCEL "A" IS INTENDED TO DESCRIBE A PARCEL OF LAND FORMERLY CONVEYED IN A DESCRIPTION RECORDED IN VOLUME 411, PAGE 522 GRANT COUNTY REGISTER OF DEEDS, THIS DESCRIPTION CONVEYS THE PARCEL TO THE CURRENT WATER LINE OF THE MISSISSIPPI RIVER AND TO THE RAILROAD RIGHT-OF-WAY PER PLAT.

PINE LAND

DESCRIPTION OF PARCEL "B"

COMMENCING AT THE NORTHEAST CORNER OF SECTION 28; THENCE SOUTH 89° 33' 00" WEST, ALONG THE NORTH LINE OF THE NORTHEAST ONE-QUARTER, 1696.03 FEET, THENCE CONTINUING SOUTH 89° 33' 00" WEST ALONG SAID NORTH LINE, 198.03 FEET TO THE PLACE OF BEGINNING OF THE PARCEL HEREINAFTER DESCRIBED; THENCE SOUTH 15° 30' 00" WEST, 259.82 FEET TO A POINT ON A LINE MEANDERING THE NORMAL LOW WATER LINE ON THE WESTERLY SHORE OF THE MISSISSIPPI RIVER; THENCE NORTH 59° 34' 47" WEST, ALONG SAID MEANDER LINE, 58.09 FEET; THENCE NORTH 38° 14' 01" WEST, ALONG SAID MEANDER LINE, 213.44 FEET TO A POINT ON THE NORTH LINE OF THE NORTHEAST ONE-QUARTER OF SECTION 28; THENCE NORTH 89° 33' 00" EAST, ALONG SAID NORTH LINE, 337.93 FEET TO THE PLACE OF BEGINNING, CONTAINING 48,350 SQ. FT. OR 1.110 ACRES OF LAND.

NOTE: THE DESCRIPTION OF PARCEL "B" IS INTENDED TO CONVEY ALL THAT LAND WHICH HAS BEEN OCCUPIED BY THE RESORT THAT LIES SOUTH OF THE SECTION LINE BETWEEN SECTION 21 AND SECTION 28. THIS IS PART OF A PARCEL FORMERLY CONVEYED ON A DEED RECORDED IN VOLUME 174, PAGE 367, GRANT COUNTY REGISTER OF DEEDS, DATED MARCH 18, 1913. THERE MAY NOT BE ANY RECORD EVIDENCE ESTABLISHING TITLE IN THIS PORTION OF LAND TO THE RESORT.

I HAVE SURVEYED THE PROPERTY DEPICTED HEREON AND THIS IS A CORRECT REPRESENTATION THEREOF AND SHOWS THE SIZE AND LOCATION OF THE PROPERTY, ITS EXTERIOR BOUNDARIES, FENCES, ROADWAYS AND ANY VISIBLE ENCROACHMENTS, IF ANY.

THIS SURVEY IS MADE FOR THE EXCLUSIVE USE OF THE PRESENT OWNERS OF THE PROPERTY, AND ALSO THOSE WHO PURCHASE, MORTGAGE OR GUARANTEE THE TITLE THEREOF, WITHIN ONE (1) YEAR HEREOF; AND AS TO THEM I HEREBY CERTIFY THAT SAID SURVEY AND THIS MAP WERE MADE IN ACCORDANCE WITH ACCEPTABLE PROFESSIONAL STANDARDS AND THE INFORMATION CONTAINED HEREON IS TO THE BEST OF MY KNOWLEDGE, INFORMATION AND BELIEF A TRUE REPRESENTATION THEREOF.

THE LAND DEPICTED HEREON IS OCCUPIED PRIMARILY BY COTTAGES.

SOUTH LINE SECTION 21
S 89°33'00" W 1696.03
S 89°33'00" W 2231.88'

BENCHMARK SURVEYS OF SOUTHWESTERN WISCONSIN, INC.
P. O. BOX 480 RICHLAND CENTER, WIS. 53581 (808) 647-8533
PROJECT NUMBER 1116
JUNE 11, 1993
DRAFTED BY: SMW
SHEET 1 OF 1

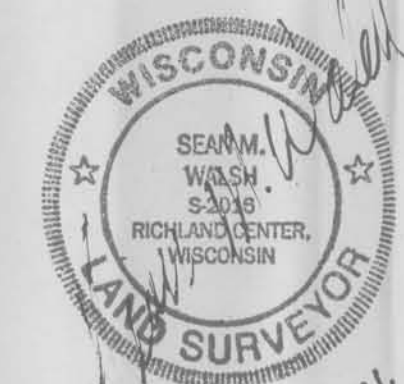

JUNE 11, 1993

SOUTHEAST CORNER SECTION 21 ALUMINUM MONUMENT LOCATED

PARCEL "B"
48,350 SQ. FT
1.110 ACRES

THERE APPEARS TO BE NO RECORD EVIDENCE OF TITLE TO PARCEL "B" THOUGH IT HAS BEEN OCCUPIED BY THE RESORT FOR MANY YEARS

