

SURVEY PLAT

- CHERYL CALEY -

OF A PARCEL OF LAND LOCATED IN THE SE 1/4 OF THE SE 1/4 OF SECTION 14 AND IN THE NE 1/4 OF THE NE 1/4 OF SECTION 23, ALL OF T 3 N, R 3 W OF THE 4TH P.M., GRANT CO., WISC, AND BEING MORE PARTICULARLY DESCRIBED AS FOLLOWS:

COMMENCING AT THE SE CORNER OF LOT 1, CERTIFIED SURVEY MAP # 293, RECORDED IN VOLUME 2 ON PAGE 81 AND 82 OF CERTIFIED SURVEY MAPS, GRANT CO. REGISTRY; SAID CORNER BEING THE POINT OF BEGINNING;

THENCE S 60°53'16" E 45.66' TO THE CENTERLINE OF STH # 35 AND USH # 61;

THENCE SW'LY 46.95' ALONG SAID CENTERLINE AND THE ARC OF A CURVE CONCAVE NW'LY HAVING A RADIUS OF 1910.00' AND A LONG CHORD WHICH BEARS S 32°05'23"W 46.95';

THENCE S 31°14'19" W 96.27' ALONG SAID CENTER LINE;

THENCE N 77°06'22" W 212.82';

THENCE N 18°35'57" E 100.13';

THENCE N 69°44'26" W 95.25';

THENCE N 13°16'55" E 48.38';

THENCE S 72°35'05" E 96.86';

THENCE N 15°09'18" E 39.60';

THENCE S 71°16'05" E 78.39';

THENCE S 60°53'16" E 127.88' TO THE POINT OF BEGINNING, CONTAINING 1.01 ACRES, MORE OR LESS, AND BEING SUBJECT TO ANY AND ALL EASEMENTS OF RECORD, INCLUDING, BUT NOT LIMITED TO HIGHWAY CONVEYANCES OF RECORD AND TO AN EASEMENT FOR INGRESS-EGRESS, SAID EASEMENT BEING DESCRIBED AS FOLLOWS: COMMENCING AT THE SE CORNER OF LOT 1 OF C.S.M. # 293, RECORDED IN VOLUME 2 ON PAGES 81 AND 82 OF CERTIFIED SURVEY MAPS, GRANT COUNTY REGISTRY;

THENCE S 60°53'16" E 45.66' TO THE CENTER LINE OF S.T.H. # 35 AND U.S.H. # 61; THENCE SW'LY 46.95' ALONG SAID CENTER LINE AND THE ARC OF A CURVE CONCAVE NW'LY HAVING A RADIUS OF 1910.00' AND A LONG CHORD WHICH BEARS S 32°05'23" W 46.95'; THENCE S 31°14'19" W 55.32' ALONG SAID CENTER LINE TO THE POINT OF BEGINNING; THENCE S 31°14'19" W 40.95' ALONG SAID CENTER LINE; THENCE N 77°06'22" W 159.24'; THENCE N 35°53'42" E 42.23'; THENCE S 77°06'22" E 155.63' TO THE POINT OF BEGINNING.

JUN 14 1993

SURVEYOR'S CERTIFICATE: I, LARRY L. AUSTIN, REGISTERED WISCONSIN LAND SURVEYOR, DO HEREBY CERTIFY THAT I HAVE SURVEYED, MAPPED AND MONUMENTED THAT PROPERTY SHOWN HEREON IN ACCORDANCE WITH THE INSTRUCTIONS OF CHERYL CALEY AND TO THE BEST OF MY KNOWLEDGE AND BELIEF, THIS PLAT IS AN ACCURATE REPRESENTATION THEREOF.

Larry L. Austin
 LARRY L. AUSTIN RLS 1903
 LARRY AUSTIN ENGINEERING
 RT. 2, LANCASTER, WI. 608-723-6363

12/15/92
DATE

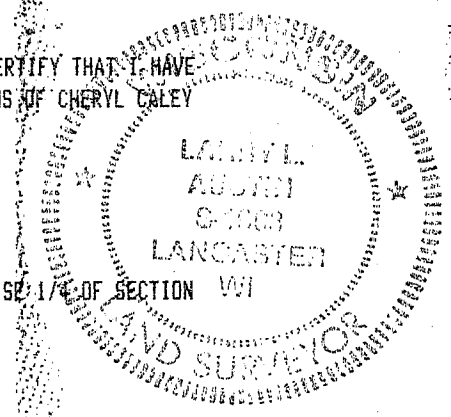

BEARING REFERENCE: FOR PURPOSES OF THIS SURVEY BEARINGS ARE REFERENCED TO THE SOUTH LINE OF SE 1/4 OF SECTION 14, BEARING N 89 04'12" W - GRID.

