

Sec 35, T3N, R3W

117

FOR: MIDWEST TITLE CORP.  
LANCASTER, WI

- CASE # 6652TR  
- RONALD BODE

STATEMENTS REGARDING WORK TO BE DONE:

AS CLIENT(S) OF LARRY L. AUSTIN, WISCONSIN LAND SURVEYOR, I/WE HEREBY REQUEST THAT THE SURVEY BE MADE ACCORDING TO THE FOLLOWING SPECIFICATIONS:

- 1) ONLY ENOUGH WORK BE PERFORMED TO SATISFY THE REQUIREMENTS OF:  
MIDWEST TITLE CORP.  
LANCASTER, WI
- 2) NO STAKES BE SET TO MARK THE CORNERS OF THE PARCEL.
- 3) THE EXACT LENGTH AND BEARINGS OF THE BOUNDARIES OF THE PARCEL NEED NOT BE SHOWN.
- 4) MEASUREMENTS NEED NOT BE TAKEN AS SPECIFIED IN A-E 7.06 OF THE WISCONSIN ADMINISTRATIVE CODE. IT IS SPECIFICALLY INTENDED TO EXEMPT THIS SURVEY FROM THE REQUIREMENTS OF A-E 7.05 (3), 7.06 AND A-E 7.07 OF THE WISCONSIN ADMINISTRATIVE CODE.

DATE \_\_\_\_\_

SURVEYOR'S CERTIFICATE: I HEREBY CERTIFY THAT I HAVE SURVEYED THE ABOVE PARCEL AND THAT THE MAP SHOWN HEREON IS A TRUE AND CORRECT REPRESENTATION THEREOF TO THE BEST OF MY KNOWLEDGE AND BELIEF, AND SHOWS THE SIZE AND LOCATION OF THE PARCEL, IT'S RECORDED EXTERIOR BOUNDARIES, THE LOCATION OF VISIBLE ROADWAYS AND ENCROACHMENTS, IF ANY. THIS SURVEY IS MADE FOR THE USE OF THE PRESENT OWNERS OF THE PROPERTY AND THOSE WHO PURCHASE, MORTGAGE, OR GUARANTEE TITLE THEREIN WITHIN ONE YEAR FROM THE DATE HEREON.

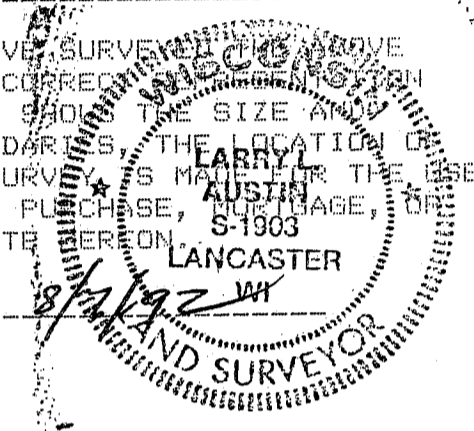

*Larry L. Austin*  
LARRY L. AUSTIN, RLS 1903

DATE *8/14/92*

LARRY AUSTIN ENGINEERING  
RT. 2  
LANCASTER, WISCONSIN 53813  
PHONE (608) 723-6363

DESCRIPTION PROVIDED: A FACEL OF LAND LOCATED IN LOT TWENTY-SIX (26) OF THE SUBDIVISION OF SECTION THIRTY-FIVE (35) AND IN THE NORTHWEST QUARTER (N.W.1/4) OF THE SOUTHWEST QUARTER (S.W.1/4) OF SECTION THIRTY-FIVE (35), TOWNSHIP THREE (3) NORTH, RANGE THREE (3) WEST OF THE 4TH P.M., VILLAGE OF FOTOSI, GRANT COUNTY, WISCONSIN, DESCRIBED AS FOLLOWS:  
COMMENCING AT THE SOUTHWEST CORNER OF SAID SECTION 35;  
THENCE NORTH 2432.75 FEET ;  
THENCE NORTH 85° 53' 30" EAST 547.80 FEET;  
THENCE SOUTH 85° 49' 30" EAST 268.92 FEET TO THE POINT OF BEGINNING;  
THENCE NORTH 04° 10' 30" EAST 180.00 FEET;  
THENCE SOUTH 85° 49' 30" EAST 136.00 FEET;  
THENCE SOUTH 04° 10' 30" WEST 180.00 FEET;  
THENCE NORTH 85° 49' 30" WEST 136.00 FEET TO THE POINT OF BEGINNING,  
CONTAINING 0.5620 ACRES, MORE OR LESS.

