

Sec 36, T3N, R3W

105

PLAT OF SURVEY

BRUCE KRUSER

MAR 6 1992

OF A PARCEL OF LAND LOCATED IN THE SE 1/4 OF THE SW 1/4 OF SECTION 36, T 3 N, R 3 W OF THE 4TH P.M., GRANT COUNTY, WISCONSIN, MORE PARTICULARLY DESCRIBED AS FOLLOWS:

ALL THAT PART OF THE S 1/2 OF THE SE 1/4 OF THE SW 1/4 OF SECTION 36, T 3 N, R 3 W OF THE 4TH P.M., GRANT COUNTY WISCONSIN LYING WITHIN THE FOLLOWING DESCRIBED PARCEL:

COMMENCING AT THE SW CORNER OF SECTION 36, T 3 N, R 3 W OF THE 4TH P.M., GRANT COUNTY, WISCONSIN; THENCE S 89° 58' 23" E 1318.19' ALONG THE SOUTH LINE OF SAID SECTION; THENCE N 00° 11' 09" E 310.79'; THENCE N 88° 12' 55" E 102.28' TO THE POINT OF BEGINNING;

THENCE N 00° 11' 09" E 369.68' TO A POINT IN THE CENTER LINE OF SCHAEFER DRIVE;

THENCE N 89° 58' 23" W 408.92' ALONG SAID CENTER LINE;

THENCE S 07° 35' 04" W 193.06';

THENCE N 83° 54' 55" W 288.54';

THENCE S 07° 07' 44" W 209.61';

THENCE S 88° 12' 55" W 71.74' TO THE POINT OF BEGINNING, CONTAINING 1.971 ACRES, MORE OR LESS, AND BEING SUBJECT TO ANY AND ALL EASEMENTS OF RECORD.

SURVEYOR'S CERTIFICATE: I, LARRY L. AUSTIN, REGISTERED WISCONSIN LAND SURVEYOR, DO HEREBY CERTIFY THAT I HAVE SURVEYED, MAPPED AND MONUMENTED THAT PROPERTY SHOWN HEREON IN ACCORDANCE WITH THE INSTRUCTIONS OF BRUCE KRUSER, AND TO THE BEST OF MY KNOWLEDGE AND BELIEF, THIS PLAT IS AN ACCURATE REPRESENTATION THEREOF.

Larry L. Austin
LARRY L. AUSTIN RLS 1903
LARRY AUSTIN ENGINEERING
RT. 2
LANCASTER, WI. 53813
PHONE (608) 723-6363

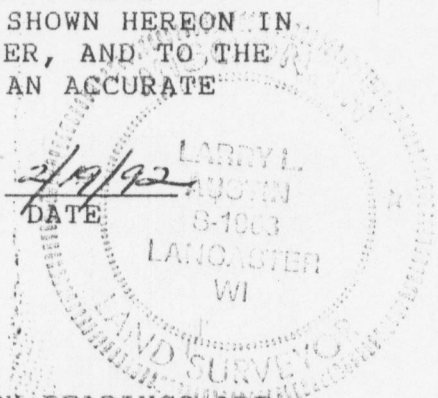

BEARING REFERENCE: FOR PURPOSES OF THIS SURVEY BEARINGS ARE REFERENCED TO THE SOUTH LINE OF THE SW 1/4 OF SECTION 36, T 3 N, R 3 W; ASSUMED BEARING = S 89° 58' 23" E

