

Sec 34, T3N, R3W
PLAT OF SURVEY*

103

ST. THOMAS RECTORY
 - WINKLER REALTY
 - FATHER STEVE SMITH

LEGAL DESCRIPTION:

INLOT 66 AND THAT PORTION OF INLOT 64 AND INLOT 62 DESCRIBED AS FOLLOWS; COMMENCING AT THE SW CORNER OF INLOT 66, SAID CORNER BEING THE POINT OF BEGINNING; THENCE S 56° 48' 00" E 132.00' TO THE SE'LY CORNER OF SAID INLOT 66; THENCE S 33° 12' 00" W 67.00' ALONG THE EASTERLY LINES OF INLOT 64 AND 62; THENCE N 51° 36' 20" W 132.54' TO THE WESTERLY LINE OF SAID INLOT 64; THENCE N 33° 12' 00" E 55.00' TO THE POINT OF BEGINNING, ALL BEING OF THE PLAT OF THE VILLAGE OF POTOSI, BEING A PART OF THE SUBDIVISION OF SECTION 34, T 3 N, R 3 W OF THE 4TH P.M., GRANT COUNTY, WISCONSIN.

SURVEYOR'S CERTIFICATE: I, LARRY L. AUSTIN, REGISTERED WISCONSIN LAND SURVEYOR, DO HEREBY CERTIFY THAT I HAVE SURVEYED, MAPPED AND MONUMENTED THAT PROPERTY SHOWN HEREON IN ACCORDANCE WITH THE INSTRUCTIONS OF FATHER STEVE SMITH, AND TO THE BEST OF MY KNOWLEDGE AND BELIEF, THIS PLAT IS AN ACCURATE REPRESENTATION THEREOF.

Larry L. Austin
 LARRY L. AUSTIN RLS 1903
 LARRY AUSTIN ENGINEERING
 RT. 2
 LANCASTER, WI. 53813
 PHONE (608) 723-6363

2/15/91
 DATE
 * REVISED 11-1-91
L. Austin

BEARING REFERENCE: FOR PURPOSES OF THIS SURVEY BEARINGS ARE REFERENCED THE THE WESTERLY LINES OF LOTS 60 THRU 66, WHICH IS ASSUMED TO BEAR S 33° 12' 00" W.

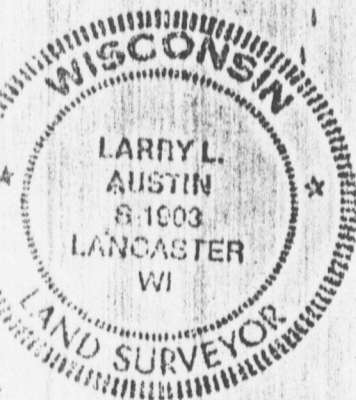

- LEGEND
- 1"x24" IRON PIPE SET
 - 1"x16" IRON PIPE SET ON BEDROCK (WITH STONES PILED AROUND)
 - 1 1/4" BAR FOUND
 - 3/4" BAR FOUND
 - △ DRILLED HOLE WITH LEAD FOUND
 - () RECORDED DIMENSION OR BRG.

