

12-1-1

Q/92

SURVEY PLAT

GEORGE GULER

OF THAT PROPERTY DESCRIBED IN VOLUME 660, PAGE 588, GRANT COUNTY REGISTRY SAID PROPERTY PURPORTED TO BE IN PART OF THE NW 1/4 OF THE SE 1/4 OF SECTION 12, T 1 N, R 1 W OF THE 4TH P.M., GRANT COUNTY, WISCONSIN, AND MORE PARTICULARLY DESCRIBED AS FOLLOWS:

PARCEL 1: GULERS TAVERN AND RESIDENCE

COMMENCING AT A FOUND STONE MONUMENT AT THE SE CORNER OF SECTION 12, T 1 N, R 1 W OF THE 4TH P.M., GRANT COUNTY, WISCONSIN; THENCE N 00°00'00" E 2639.35' TO THE CENTER LINE OF S.T.H. # 11; THENCE N 89°43'45" W 1823.12' ALONG THE CENTER LINE OF SAID HIGHWAY TO A POINT OF THE WESTERLY R.O.W. OF S.T.H. # 80 AND THE POINT OF BEGINNING;

THENCE CONTINUING N 89°43'45" W 207.76' ALONG THE EXTENSION OF SAID S.T.H. # 11 CENTER LINE;

THENCE S 00°16'16" W 206.02';

THENCE S 81°05'33" E 166.93' TO THE EASTERLY R.O.W. OF SAID S.T.H. 80;

THENCE N 10°44'45" E 235.00' ALONG SAID R.O.W. TO THE POINT OF BEGINNING, CONTAINING 0.941 ACRES, MORE OR LESS

AND BEING SUBJECT TO ANY AND ALL EASEMENTS OF RECORD, AND ALSO INCLUDING, BUT NOT LIMITED TO A 33' WIDE, MEASURED PERPENDICULARLY, EASEMENT FOR INGRESS-EGRESS, SAID EASEMENT BEING LOCATED NORTH OF AND ADJACENT TO THE SOUTHERLY LINE OF THE ABOVE DESCRIBED PARCEL.

PARCEL 2: SWISS HAUS

COMMENCING AT A FOUND STONE MONUMENT AT THE SE CORNER OF SECTION 12, T 1 N, R 1 W OF THE 4TH P.M., GRANT COUNTY WISCONSIN; THENCE N 00°00'00" E 2639.35' TO THE CENTER LINE OF S.T.H. # 11; THENCE N 89°43'45" W 2030.88' ALONG THE CENTER LINE OF S.T.H. # 11 AND THE EXTENSION OF SAID CENTER LINE TO THE POINT OF BEGINNING;

THENCE S 00°16'16" W 206.02';

THENCE N 81°05'33" W 606.11';

THENCE N 00°00'00" E 115.00' TO THE EXTENSION OF THE CENTER LINE OF S.T.H. # 11;

THENCE S 89°43'45" E 599.24' ALONG SAID EXTENSION TO THE POINT OF BEGINNING, CONTAINING 2.208 ACRES, MORE OR LESS, AND BEING SUBJECT TO ANY AND ALL EASEMENTS OF RECORD.

SURVEYOR'S CERTIFICATE: I, LARRY L. AUSTIN, REGISTERED WISCONSIN LAND SURVEYOR, DO HEREBY CERTIFY THAT I HAVE SURVEYED, MAPPED, AND MONUMENTED THAT PROPERTY SHOWN HEREON IN ACCORDANCE WITH THE INSTRUCTIONS OF GEORGE GULER AND THAT TO THE BEST OF MY KNOWLEDGE AND BELIEF, THIS PLAT IS AN ACCURATE REPRESENTATION THEREOF.

Larry L. Austin
LARRY L. AUSTIN RLS 1903
LARRY AUSTIN ENGINEERING
RT. 2
LANCASTER, WISCONSIN 53813
PHONE (608) 723-6363

8/18/91
DATE
REVISED 9/3/97 AJA

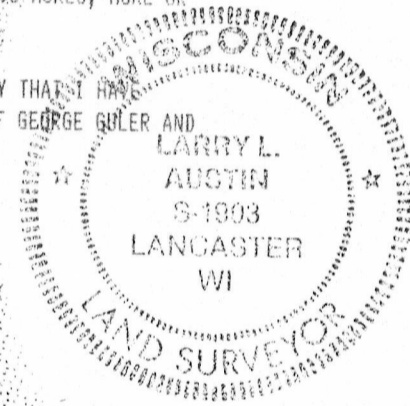

BEARING REFERENCE: FOR PURPOSES OF THIS SURVEY BEARINGS ARE REFERENCED TO THE EAST LINE OF THE SE 1/4 OF SAID SECTION 12, WHICH IS ASSUMED TO BEAR NORTH.

