

Sec 25 T5N R5W

45

BENCHMARK SURVEYS, INC.
P.O. BOX 486 608/647-8533
RICHLAND CENTER, WISCONSIN 53581

PLAT OF SURVEY
FOR



SCALE 1" = 50' **ANN J. GRAF & TERRY REUKAUF**

LOCATED IN PART OF THE NORTHWEST ONE-QUARTER OF SECTION 25, TOWNSHIP 5 NORTH, RANGE 5 WEST, VILLAGE OF BLOOMINGTON, GRANT COUNTY, WISCONSIN.

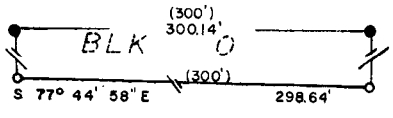

THIRD STREET

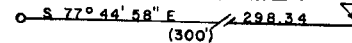

NORTHEAST CORNER OF BLOCK P TAFY'S ADDITION

PARCELS ARE OCCUPIED TO FENCE TO THE EAST SHED IS OFF PARCEL A.

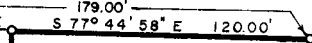

PARCEL A
DWELLING

13,198 SQ. FT.
0.303 ACRES

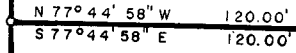

PARCEL B
VACANT

12,989 SQ. FT.
0.298 ACRES

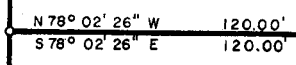

PARCEL C
VACANT

12,989 SQ. FT.
0.298 ACRES

VOLUME 255 PAGE 617

SECOND STREET IS NOT CONSTRUCTED EAST OF FRONT STREET

LEGEND

- - 1" Ø IRON PIPE FOUND
- - 3/4" X 24" IRON ROD PLACED
- △ - RAILROAD SPIKE FOUND
- () - PLATTED DIMENSION
- * * - EXISTING FENCE

BLK P

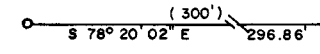

SECOND STREET

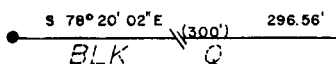

"I HAVE SURVEYED THE ABOVE DESCRIBED PROPERTY, AND THE ABOVE MAP IS A TRUE REPRESENTATION THEREOF AND SHOWS THE SIZE AND LOCATION OF THE PROPERTY, ITS EXTERIOR BOUNDARIES, THE LOCATION AND DIMENSIONS OF ALL STRUCTURES THEREON, FENCES, ROADWAYS, APPARENT EASEMENTS AND ENCROACHMENTS, IF ANY.

THIS SURVEY IS MADE FOR THE EXCLUSIVE USE OF THE PRESENT OWNERS OF THE PROPERTY, AND ALSO THOSE WHO PURCHASE, MORTGAGE OR GUARANTEE THE TITLE THEREOF, WITHIN ONE (1) YEAR FROM DATE HEREOF; AND AS TO THEM I HEREBY CERTIFY THAT SAID SURVEY AND THE ABOVE MAP WERE MADE IN ACCORDANCE WITH ACCEPTABLE PROFESSIONAL STANDARDS AND THAT THE INFORMATION CONTAINED HEREON IS, TO THE BEST OF MY KNOWLEDGE, INFORMATION AND BELIEF A TRUE AND ACCURATE REPRESENTATION THEREOF."

DATED August 29, 1991

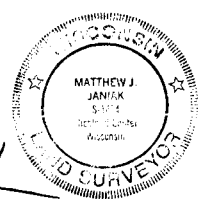

DRAFTED BY: S. WALSH

SHEET 1 OF 3

JOB NO. 779

BENCHMARK SURVEYS, INC.

August 29, 1991

OCT 15 1991

Description for: ANN J. GRAF & TERRY REUKAUF
Agent: Attorney Ivars Kalnins

PARCEL "C"

All that part of the Northwest One-quarter (NW $\frac{1}{4}$) of the Northwest One-quarter (NW $\frac{1}{4}$) of Section 25, Township 5 North, Range 5 West, Village of Bloomington, Grant County, Wisconsin, bounded and described as follows:

Commencing at the Northeast Corner of Block "P" of Taft's Addition to the Village of Bloomington; thence South 77° 44' 58" East, on the extension of the North Line of said Block "P", 179.00 feet; thence South 13° 04' 57" West, parallel to Front Street, 217.96 feet to the place of beginning of the parcel hereinafter described; thence continuing South 13° 04' 57" West, parallel to Front Street, 107.96 feet to a point on the centerline of former Second Street; thence North 78° 20' 02" West, along said centerline, 120.00 feet to a point on the East Line of Front Street; thence North 13° 04' 57" East, along said East Line, 108.57 feet; thence South 78° 02' 26" East, 120.00 feet to the place of beginning, containing 12,989 square feet or 0.298 acres of land.



8-29-91

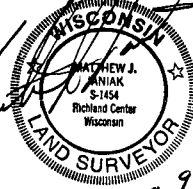

BENCHMARK SURVEYS, INC.

P.O. Box 486
133 N. Central Ave.
Valley Bank Building
Richland Center, WI 53581

(608) 647-8533

August 29, 1991

Description for: **ANN J. GRAP & TERRY REUKAUF**
Agent: **Attorney Ivars Kalnins**

PARCEL "A"

All that part of the Northwest One-quarter (NW $\frac{1}{4}$) of the Northwest One-quarter (NW $\frac{1}{4}$) of Section 25, Township 5 North, Range 5 West, Village of Bloomington, Grant County, Wisconsin, bounded and described as follows:

Commencing at the Northeast Corner of Block "P" of Taft's Addition to the Village of Bloomington; thence South 77° 44' 58" East, on the extension of the North Line of said Block "P", 59.00 feet to a point on the East Line of Front Street and the place of beginning of the parcel hereinafter described; thence continuing South 77° 44' 58" East, along said extension, 120.00 feet; thence South 13° 04' 57" West, parallel to Front Street, 110.00 feet; thence North 77° 44' 58" West, parallel to the extension of the North Line of Block "P" of Taft's Addition, 120.00 feet to a point on the East Line of Front Street; thence North 13° 04' 57" East, along said East Line, 110.00 feet to the place of beginning, containing 13,198 square feet or 0.303 acres of land.

PARCEL "B"

All that part of the Northwest One-quarter (NW $\frac{1}{4}$) of the Northwest One-quarter (NW $\frac{1}{4}$) of Section 25, Township 5 North, Range 5 West, Village of Bloomington, Grant County, Wisconsin, bounded and described as follows:

Commencing at the Northeast Corner of Block "P" of Taft's Addition to the Village of Bloomington; thence South 77° 44' 58" East, on the extension of the North Line of said Block "P", 179.00 feet; thence South 13° 04' 57" West, parallel to Front Street, 110.00 feet to the place of beginning of the parcel hereinafter described; thence continuing South 13° 04' 57" West, parallel to Front Street, 107.96 feet; thence North 78° 02' 26" West, 120.00 feet to a point on the East Line of Front Street; thence North 13° 04' 57" East, along said East Line, 108.57 feet; thence South 77° 44' 58" East, 120.00 feet to the place of beginning, containing 12,989 square feet or 0.298 acres of land.

