

PLAT OF SURVEY for KENNETH THOMASON

RIDER SHEET: 486450

APR 17 1991

VOL. 575 PAGE 224

Parcel 1: Beginning at the Northeast corner of the Northwest Quarter (NW 1/4) of the Southeast Quarter (SE 1/4) of Section Twenty-six (26), Town Three (3) North, Range Three (3) West of the 4th P.M., Grant County, WI, thence West 4.45 chains, thence South 3.45 chains, thence South 37° East 2.36 chains, thence North 47° East 4.95 chains, thence North 45° West 98 links, thence North 1 chain to the place of beginning. Also beginning at the Northeast corner of the Northwest Quarter (NW 1/4) of the Southeast Quarter (SE 1/4) of said Section Twenty-six (26); thence West 293.70 feet; thence North 76.50 feet; thence South 80° 51' East 313.30 feet; thence South 22° 38' West 38.65 feet to the place of beginning.

Parcel 2: Lots 1, 2, 3, 4, 5, 6, 7, 19 and 21 in Section 26, Town Three (3) North, Range Three (3) West of the 4th P.M., according to the recorded plat of British Hollow in the Township of Potosi, Grant County, WI.

EXCEPTION TO WARRANTY: Grantor excepts from the warranty clause the land described in Parcel 2 and as to this land Grantor quit claims all rights and interest to the Grantees.

I, Bruce D. Bowden, Registered Wisconsin Land Surveyor S-1250, do hereby certify that I have surveyed, mapped and monumented the property shown hereon in accordance with the information and instructions furnished by Mr. Kenneth Thomason and that this map is a correct representation thereof to the best of my knowledge and belief.

Bruce D. Bowden
Bruce D. Bowden
April 16, 1991
R.L.S. - 1250



- LEGEND**
- #6 x 24" REBAR SET AT DESCRIBED CORNERS
 - DESCRIBED PROPERTY LINES
 - ▲ #5 x 24" REBAR FOUND AT RIGHT-OF-WAY CORNERS, WISC. DEPT. OF TRANS. - PROJ. NO. 1650-01-21
 - RIGHT-OF-WAY LINE
 - ▣ EXISTING 1" PIPE FROM JAMES KEENE'S 1961 SURVEY
 - BOUNDARY LINE
 - - - RECORDED LOT LINES OF "MAP OF PLEASANT VALLEY" a.k.a. BRITISH HOLLOW, VOL. 5, PAGE 178
 - CAST ALUMINUM MONUMENT
 - #6x24" REBAR SET AT PROPOSED RIGHT-OF-WAY LINE
 - () RECORDED AS

NOTE: BEARINGS ARE REFERENCED TO GRID NORTH AS SHOWN ON STATE HWY. PLAN 1650-01-21.

SCALE: 1" = 40'

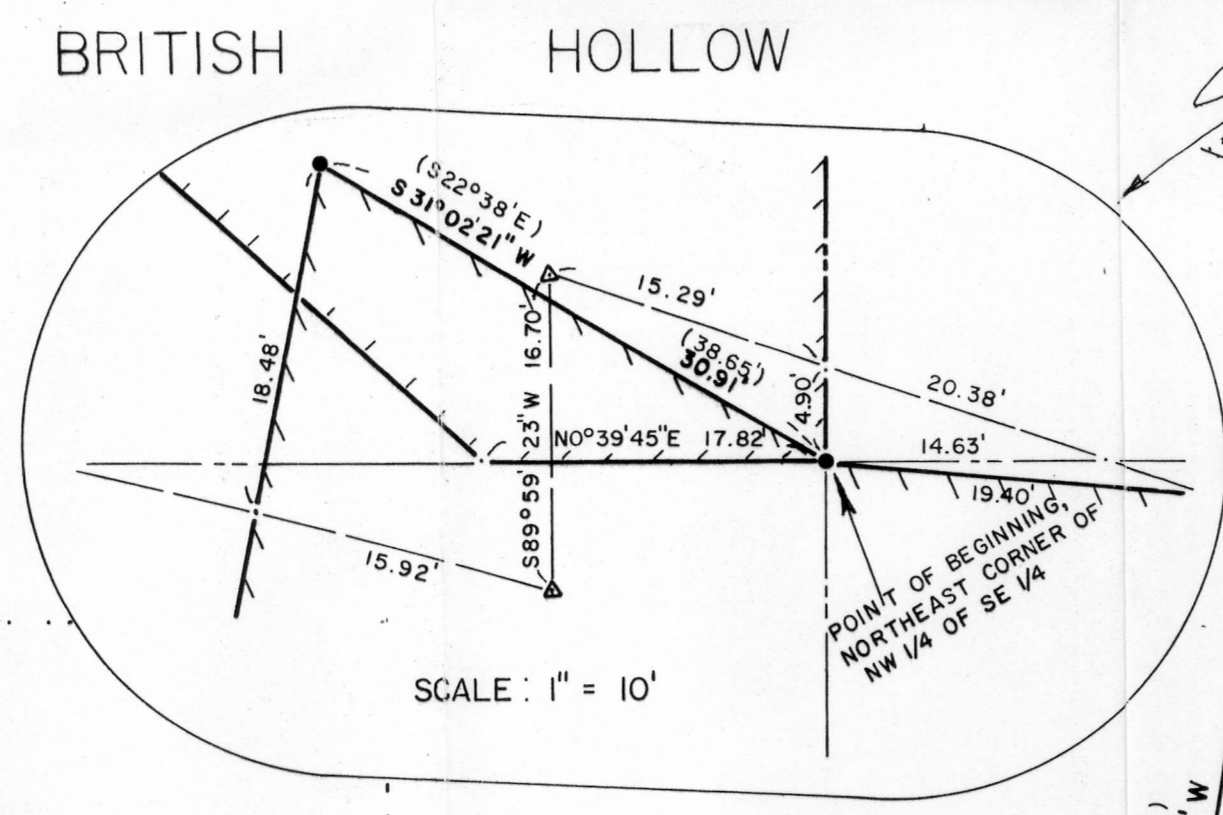
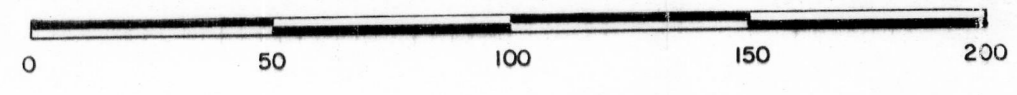

BOWDEN SURVEYING

704 NORTH MAIN STREET
DODGEVILLE, WI. 53533
PHONE (608) 935 - 5513