

CERTIFIED LAND CORNER

Sec. 21, T3N, R4W,

STATE OF WISCONSIN )  
 COUNTY OF GRANT ) s.s.

CERTIFICATE

I, David A. Davis, do hereby certify that on the 18 day of May 1981, I found (evidence) ~~(no evidence)~~ of the Northeast corner of Section 21, T3N, R4W, Fourth Principal Meridian, and I re-established said corner according to the Wisconsin Statutes as shown and described hereon.

Dated this 22 day of May 1981

David A. Davis  
 registered land surveyor.  
 Title

*David A. Davis*

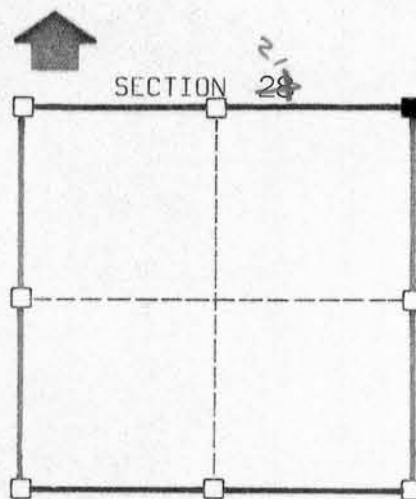
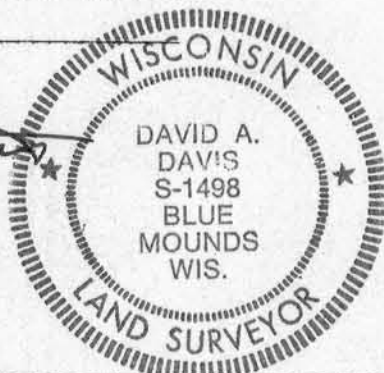

T 3 N R 4 W  
 Town of: Waterloo

Seal

History of original corner establishment:

No record since original government survey.

Description of corner evidence found:

Old fence running east-west. Old fence to north of corner.  
 Corner set at projected intersection of fences.

Description of corner and witness monuments, references and accessories used to perpetuate the original or re-established location of this corner:

Witnesses to corner location:

Jim Olson  
Garth Althaus

Sketch:

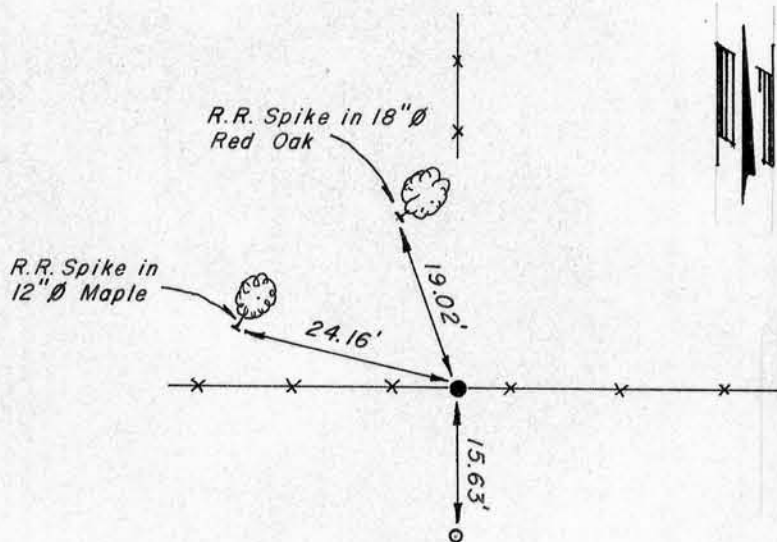

Legend

- NO. 10 (1-1/4" Ø) REBAR
- NO. 6 (3/4" Ø) REBAR
- ☺ TREE
- x — x — FENCELINE

SURVEY CONTROL ORDER

Horizontal
Vertical

WISCONSIN COORDINATE SYSTEM

Corner	East(X)	North(Y)	Elevation(Z)	Zone
Control Sta. Name				

JUL 6 1981

PAGE