

CERTIFIED LAND CORNER

Sec. 4, Town 3 N, Range 2 W

STATE OF WISCONSIN)
 COUNTY OF GRANT) S.S.

CERTIFICATE

I, David A. Davis, do hereby certify that on the 10th day of June 1981, I found ~~(evidence)~~ (no evidence) of the Southwest corner of Section 4, T 3 N, R 2 W, Fourth Principal Meridian, and I re-established said corner according to the Wisconsin Statutes as shown and described hereon.

Dated this 11 day of June 1981

David A. Davis
 registered land surveyor.

Title



Seal

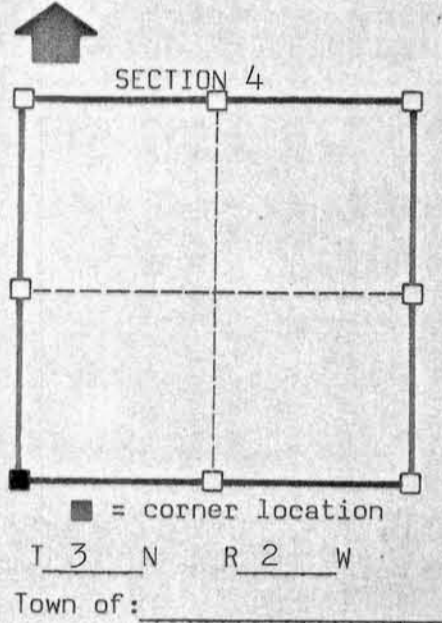

History of original corner establishment:
 None since original government survey.

Description of corner evidence found:
 Fence north-south on line with fence to west.

Description of corner and witness monuments, references and accessories used to perpetuate the original or re-established location of this corner:

Witnesses to corner location:
Jim Olson
Garth Althaus

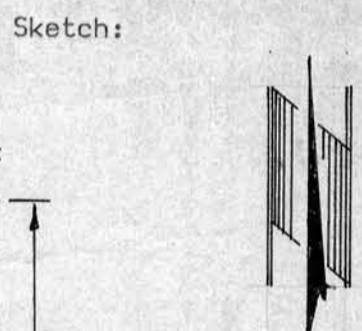

- Legend**
- x — Fenceline
 - o No. 6 (3/4" Ø) Rebar
 - ⊥ Railroad Spike

SURVEY CONTROL ORDER

Horizontal
Vertical

Corner	East(X)	North(Y)	Elevation(Z)	Zone
Control Sta. Name				

WISCONSIN COORDINATE SYSTEM

JUL 6 1981

PAGE _____