

DAVIES MEMORIAL UNITED CHURCH OF CHRIST - RANDY GABLE SURVEY



- LEGEND:**
- 1" X 24" IRON PIPE PLACED BY THIS SURVEY
 - NAIL PLACED BY THIS SURVEY

DESCRIPTION:

Part of Inlots 157 and 159 of the Village of Potosi, Grant County, Wisconsin, according to the recorded map or plat thereof, being more particularly described as follows to-wit:

Commence at the Southeast corner of said Inlot 157 at a point where the North line of White Street intersects with the West line of North Street;

thence Northwesterly 102.00 feet along the Southwestern boundary of said Inlot 157 to the point of beginning;

thence Northwesterly 40.00 feet along the Southwestern boundary of said Inlot 157 to the Eastern boundary of an alley;

thence Northeasterly 122.10 feet along the Eastern boundary of said alley, said boundary being parallel to North Street;

thence Southeasterly 70.65 feet along a line parallel to the Northeastern boundary of said Inlot 159;

thence Southwesterly 56.10 feet along a line parallel to North Street, to a point on the Northeastern boundary of said Inlot 157;

thence Northwesterly 30.65 feet along the Northeastern boundary of said Inlot 157;

thence Southwesterly 66.00 feet along a line parallel to North Street, to a point on the Southwestern boundary of said Inlot 157 and the point of beginning.

I certify that I have surveyed the above described parcel of land and that the attached or accompanying plat is an accurate survey and true representation thereof and correctly shows the exterior boundary lines of said parcel and the correct measurements thereof.

Dated this 5th day of August, 1977.

David K. Krohn
 DAVID K. KROHN
 REG. NO. 1309
 5/26/77 - 8/5/77

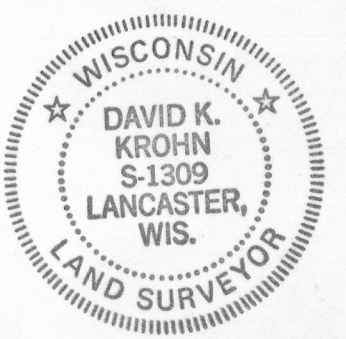

SCALE: 1" = 30'

