

96,000.00  
50,000.00

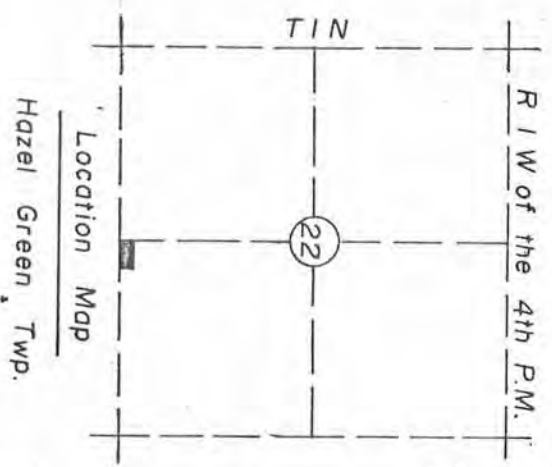
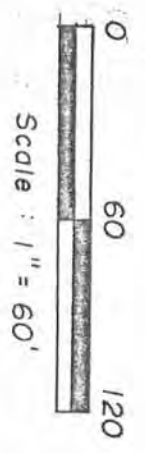

### LEGEND

- Boundary of Property Surveyed
- 3/4" x 36" Iron Pin Set (1.58 lbs./ft.)
- Existing Iron Pin

Sheet 1 of 2

GALENA, ILL. **SCHOENHARD DIVISION** DUBUQUE, IOWA

**BERT B. HANSON AND ASSOCIATES**  
Consulting Engineers  
Civil - Structural - Sanitary - Highway - Electrical

DRAWN BY CBS	DATE DRAWN May 11 1979	SCALE 1" = 60'	REVISIONS
CHECKED BY CBS	APPROVED BY CBS	FIELD BK. 2-V-78	BY
SURVEYED BY CBS, DLL, JM, WK		DATE	

DATE May 4, 1979	Proj. No. 124-79412
TITLE Rosanne Runde	NO. 24-W1-79

ROSANNE RUNDE  
CERTIFIED SURVEY MAP

DESCRIPTION:

A PART OF THE SOUTHWEST QUARTER (SW $\frac{1}{4}$ ) OF THE SOUTHEAST QUARTER (SE $\frac{1}{4}$ ) OF SECTION 22, TOWNSHIP 1 NORTH, RANGE 1 WEST OF THE FOURTH PRINCIPAL MERIDIAN, BOUNDED AND DESCRIBED AS FOLLOWS, TO-WIT:

BEGINNING AT THE SOUTHWEST CORNER OF THE SOUTHWEST QUARTER (SW $\frac{1}{4}$ ) OF THE SOUTHEAST QUARTER (SE $\frac{1}{4}$ ) OF SAID SECTION 22; THENCE NORTH 01 DEGREE - 28 MINUTES - 56 SECONDS EAST, (ALL BEARINGS IN THIS DESCRIPTION ARE RELATIVE TO AN ASSUMED BEARING OF NORTH 90 DEGREES - 00 MINUTES - 00 SECONDS WEST ON THE SOUTH LINE OF THE SOUTHWEST QUARTER (SW $\frac{1}{4}$ ) OF THE SOUTHEAST QUARTER (SE $\frac{1}{4}$ ) OF SAID SECTION 22) 140.56 FEET; THENCE SOUTH 90 DEGREES - 00 MINUTES - 00 SECONDS EAST, 310.00 FEET; THENCE SOUTH 01 DEGREE - 28 MINUTES - 56 SECONDS WEST, 140.56 FEET TO A POINT ON THE SOUTH LINE OF THE SOUTHWEST QUARTER (SW $\frac{1}{4}$ ) OF THE SOUTHEAST QUARTER (SE $\frac{1}{4}$ ) OF SAID SECTION 22; THENCE NORTH 90 DEGREES - 00 MINUTES - 00 SECONDS WEST ON THE SOUTH LINE OF THE SOUTHWEST QUARTER (SW $\frac{1}{4}$ ) OF THE SOUTHEAST QUARTER (SE $\frac{1}{4}$ ) OF SAID SECTION 22, 310.00 FEET TO THE POINT OF BEGINNING, CONTAINING 1.00 ACRE MORE OR LESS, BEING SUBJECT TO ROAD EASEMENTS AND ANY OTHER EASEMENTS OF RECORD.

I HEREBY CERTIFY THAT THE ATTACHED MAP WAS CAUSED TO BE SURVEYED BY ROSANNE RUNDE, AND THE ABOVE DESCRIPTION AND ATTACHED MAP ARE CORRECT AND IN ACCORDANCE WITH A SURVEY MADE BY ME OR UNDER MY DIRECT SUPERVISION ON MAY 4, 1979. I FURTHER CERTIFY THAT I HAVE FULLY COMPLIED WITH THE REQUIREMENTS OF S. 236.34 OF THE WISCONSIN STATUTES.



CARL B. SCHOENHARD, JR.  
LICENSED WISCONSIN LAND SURVEYOR  
No. S-1298



SCHOENHARD DIVISION  
BERT B. HANSON & ASSOCIATES, INC.  
CONSULTING ENGINEERS AND LAND SURVEYORS  
GALENA, ILLINOIS AND DUBUQUE, IOWA

ROSANNE RUNDE  
CERTIFIED SURVEY MAP

DESCRIPTION:

A PART OF THE SOUTHWEST QUARTER (SW $\frac{1}{4}$ ) OF THE SOUTHEAST QUARTER (SE $\frac{1}{4}$ ) OF SECTION 22, TOWNSHIP 1 NORTH, RANGE 1 WEST OF THE FOURTH PRINCIPAL MERIDIAN, BOUNDED AND DESCRIBED AS FOLLOWS, TO-WIT:

BEGINNING AT THE SOUTHWEST CORNER OF THE SOUTHWEST QUARTER (SW $\frac{1}{4}$ ) OF THE SOUTHEAST QUARTER (SE $\frac{1}{4}$ ) OF SAID SECTION 22; THENCE NORTH 01 DEGREE - 28 MINUTES - 56 SECONDS EAST, (ALL BEARINGS IN THIS DESCRIPTION ARE RELATIVE TO AN ASSUMED BEARING OF NORTH 90 DEGREES - 00 MINUTES - 00 SECONDS WEST ON THE SOUTH LINE OF THE SOUTHWEST QUARTER (SW $\frac{1}{4}$ ) OF THE SOUTHEAST QUARTER (SE $\frac{1}{4}$ ) OF SAID SECTION 22) 140.56 FEET; THENCE SOUTH 90 DEGREES - 00 MINUTES - 00 SECONDS EAST, 310.00 FEET; THENCE SOUTH 01 DEGREE - 28 MINUTES - 56 SECONDS WEST, 140.56 FEET TO A POINT ON THE SOUTH LINE OF THE SOUTHWEST QUARTER (SW $\frac{1}{4}$ ) OF THE SOUTHEAST QUARTER (SE $\frac{1}{4}$ ) OF SAID SECTION 22; THENCE NORTH 90 DEGREES - 00 MINUTES - 00 SECONDS WEST ON THE SOUTH LINE OF THE SOUTHWEST QUARTER (SW $\frac{1}{4}$ ) OF THE SOUTHEAST QUARTER (SE $\frac{1}{4}$ ) OF SAID SECTION 22, 310.00 FEET TO THE POINT OF BEGINNING, CONTAINING 1.00 ACRE MORE OR LESS, BEING SUBJECT TO ROAD EASEMENTS AND ANY OTHER EASEMENTS OF RECORD.

I HEREBY CERTIFY THAT THE ATTACHED MAP WAS CAUSED TO BE SURVEYED BY ROSANNE RUNDE, AND THE ABOVE DESCRIPTION AND ATTACHED MAP ARE CORRECT AND IN ACCORDANCE WITH A SURVEY MADE BY ME OR UNDER MY DIRECT SUPERVISION ON MAY 4, 1979. I FURTHER CERTIFY THAT I HAVE FULLY COMPLIED WITH THE REQUIREMENTS OF S. 236.34 OF THE WISCONSIN STATUTES.



CARL B. SCHOENHARD, JR.  
LICENSED WISCONSIN LAND SURVEYOR  
No. S-1298



SCHOENHARD DIVISION  
BERT B. HANSON & ASSOCIATES, INC.  
CONSULTING ENGINEERS AND LAND SURVEYORS  
GALENA, ILLINOIS AND DUBUQUE, IOWA